



morphy richards

**3 Year
Guarantee***

*Upon registering your product
at morphyrichards.co.uk

MRXWASHMAX DualClean Carpet Washer



Model No.
741000

User Manual

Please read and keep these instructions for future use





HEALTH AND SAFETY

The use of any electrical appliance requires the following common sense safety rules.

Please read these instructions carefully before using the product.

- **WARNING:** Whenever the cleaner is in use, due to the risk of entrapment in rotating parts, keep loose clothing, hair, fingers etc. away from the brush bar, nozzle and any hand-held accessories.
- **WARNING:** Disconnect from the mains supply before carrying out any routine maintenance, such as cleaning any blockages, changing any filters or accessing the floor nozzle.
- This appliance can be used by children aged from 8 years and above and persons with reduced physical, sensory or mental capabilities, or lack of experience and knowledge, if they have been given supervision or instruction concerning the use of the appliance in a safe way and understand the hazards involved.





HEALTH AND SAFETY

- Children shall not play with the appliance.
- Cleaning and user maintenance shall not be undertaken by children without supervision.
- This appliance is intended for household use only. It is not suitable for use in staff areas in shops, offices and other commercial environments.
- The appliance is not intended to be operated on an extension cable or by means of an external timer or separate remote control.



HEALTH AND SAFETY

PERSONAL SAFETY

- **WARNING:** Only lift the product by the carry handle.
- Always disconnect the appliance from the mains supply after use.
- Never use in the presence of explosive liquid or vapours.
- Never pick up flammable or poisonous liquids such as petrol, copier toner or other volatile substances. Never pick up acids, asbestos or asbestos dust.
- Never touch the plug or cable with wet hands.
- Do not immerse cord, plug or cleaner in water or other liquid.
- The appliance must never be left running unsupervised.
- The belt pulleys can become hot during normal use. To prevent burns, avoid touching the belt pulley when servicing the drive belt.

LOCATION

- Do not use or keep this product outside.
- Do not store the appliance near hot surfaces e.g. ovens or heating appliances.
- Do not place the vacuum cleaner on furniture or stairs as the brush roll may cause damage. Use extra care when cleaning stairs. Place vacuum cleaner on the floor with the handle in storage position while using attachments.

MAINS CABLE

- If the supply cord is damaged, it must be replaced by the manufacturer, its service agent, or similarly qualified person to avoid a hazard.
- Do not allow the mains lead to become strained or run this appliance over it.

PRODUCT SAFETY

- Never use the appliance without the filters being installed.
- Never use the appliance to vacuum hot ashes, broken glass, sharp objects or liquids.
- Use only Morphy Richards spare parts and accessories.
- Never modify the cleaner in any way.
- Repairs to electrical appliances are only to be undertaken by trained professionals. Unprofessional repairs can be dangerous for users.

ELECTRICAL DETAILS

- Check that the voltage on the rating plate of your appliance corresponds with your house electricity supply which must be A.C. (Alternating Current).
- Should the fuse in the mains plug require changing, replace it with a fuse of the same rating as originally fitted.
- The power consumption in off mode into which the equipment is switched automatically is 0W.
- When the appliance is not working, it enters the off mode immediately (0 minutes).



PRODUCT OVERVIEW

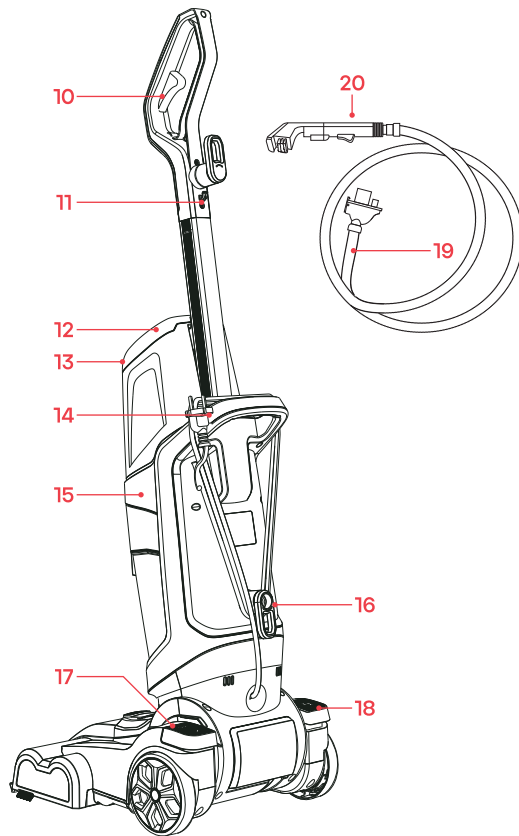
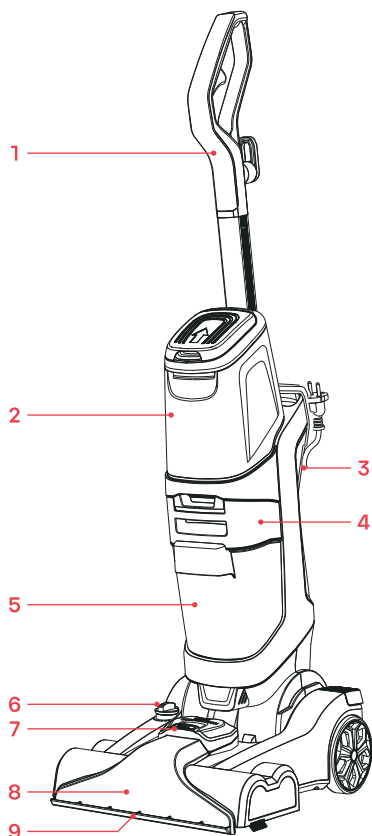

1. Handle
2. Clean water tank
3. Mains cable
4. Dirty water tank lid and release lever
5. Dirty water tank
6. Water regulating knob
7. Hose connector cover cap
8. Carpet suction nozzle
9. Roller brushes (under the main unit)
10. Water/cleaning solution dispensing lever

11. Cable mount
12. Clean water tank lid
13. Clean water tank release lever
14. Power cable upper hook
15. Clean water tank support
16. Power cable lower hook
17. Handle release pedal
18. On/off pedal
19. Upholstery hose
20. Upholstery nozzle (detachable from hose)





INTENDED USE

- The appliance is designed to be used for freshening or removing light levels of dirt on carpets and upholstered furniture. It is **NOT** a substitute for a conventional vacuum cleaner.
- Before using the appliance, the carpet or upholstered furniture which is to be treated **MUST** be thoroughly cleaned with a vacuum cleaner.
- The appliance is also suitable for use on tiles, stone floors and PVC floor covering.
- The appliance should **NEVER** be used to pick up the following.
 - Hot ashes, cigarette ends, matches, etc.
 - Flammable or explosive substances.
 - Very fine dust (e.g. concrete dust), toner or sand.
 - Pointed or hard objects such as pieces of broken glass.

BEFORE FIRST USE

Note: A cross-head screwdriver is required for assembly.

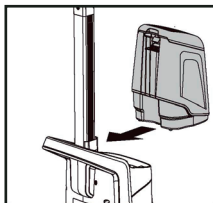
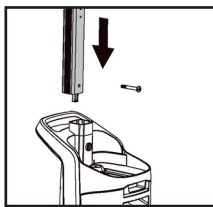

1. Unpack and check all parts are present (product overview).
2. Remove the screw that is located on the clean water tank support of the main unit.
3. Insert the handle into the opening of the clean water tank support and align it so that the curved end of the handle points towards the back of the cleaner. Fix the handle in place with the screw.
4. Attach the clean water tank into the clean water tank support. Ensure the locking lugs on the tank fit into the recesses of the clean water tank support. Press the tank against the handle until you hear it click.





USING YOUR CARPET CLEANER

- Before using your carpet washer, the carpet or upholstered furniture, which is to be cleaned, should be vacuumed thoroughly with a vacuum cleaner. If possible, use a brush attachment.
- If possible, remove all furniture from the carpet. In the case of large items of furniture which cannot be moved to one side, place plastic film below or around the feet and only remove it when the carpet has completely dried or the feet could be damaged by the moisture from the carpet.
- Check the colourfastness of the carpet or upholstered furniture. Soak a piece of white fabric with cleaning solution (follow the manufacturers' instructions for preparation of the solution) and rub it carefully on an inconspicuous spot on the carpet or upholstery. If the white fabric does not become discoloured, the carpet or upholstered furniture can be cleaned with the appliance.
- If you intend to clean carpets or upholstered furniture that has several colours, test the fastness of each colour.

FILLING THE CLEAN WATER TANK

Only add a standard carpet cleaning solution to the clean water tank and always follow the detergent manufacturers' dosing instructions. **DO NOT** use a cleaning agent that produces excessive foam, as it can affect the operation of the appliance.

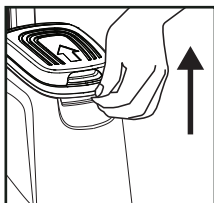

1. Press the release lever of the clean water tank upwards to release the clean water tank from the locking mechanism, it can now be lifted away from the cleaner.
2. Open the clean water tank lid add the carpet cleaning detergent and fill to the MAX mark with warm water (max. 40° C). Close the clean water tank lid.
Note: Always follow the detergent manufacturers' dosing instructions.
3. Attach the fresh water container into the clean water tank support, ensure it is securely attached.





CLEANING YOUR CARPET

Important: Never leave the carpet cleaner switched on when it is unsupervised.

Important: Always switch off the carpet cleaner before the water tanks are removed.

Important: Make sure that the carpet cleaner does not tip over as water from the water tanks could spill out. To park the carpet cleaner, move the handle to the upright position until it locks.

Important: **DO NOT** wet the carpet or the upholstered furniture excessively.

Important: If the carpet cleaner switches off during use, the built-in overheating protection has activated. Leave the carpet cleaner to cool down for approximately 60 minutes, then switch it on again using the On/Off switch.

1. Decide where cleaning should start and where it should stop so that you do not step on the carpet which has already been cleaned. We recommend that right-handed people should start at the right-hand edge of the carpet, and left-handed people should start at the left-hand edge of the carpet.
2. Cleaning solution may still escape from the device even after it has been switched off. Therefore have a towel or cloth ready on which the carpet cleaner can be placed after use.
3. Unwind the mains cable fully and insert it into the cable mount and plug it into an easily accessible mains outlet.
4. Step on the handle release pedal and tilt the handle towards you.
5. Step on the On/Off pedal to switch on the appliance.
6. Roll the appliance to a corner of the carpet.
7. As you push the cleaner forwards over the carpet, press the water/cleaning solution dispensing lever to apply cleaning solution to the carpet. The roller brushes rotate to agitate dirt from the carpet.
Note: **DO NOT** step on the wet carpet, walk to the side of the cleaner.
8. Release the water/cleaning solution dispensing lever, when you have reached the other end of the carpet.
9. Pull the carpet cleaner backwards along the same strip. The dirty water will be sucked out of the carpet.
10. Start the next strip slightly overlapping the strip of carpet that has just been cleaned.



CLEANING YOUR CARPET

11. Work up to the opposite edge of the carpet with even movements forwards and backwards.
12. If you find more stubborn patches of dirt, go over a strip several times, as necessary.
13. When the dirty water tank is full to the MAX mark, it must be emptied immediately, (see the Care & Cleaning section).
14. Whenever you empty the dirty water tank, fill the clean water tank or if cleaning is completed, place the appliance on a towel or cloth.
15. Switch off the appliance by stepping on the On/Off pedal and move the handle to secure in an upright position.
16. Remove the plug from the mains outlet.

CLEANING UPHOLSTERED FURNITURE

Use the Upholstery hose and nozzle to clean upholstered furniture.

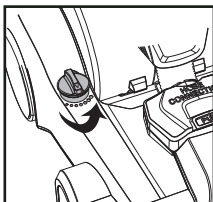
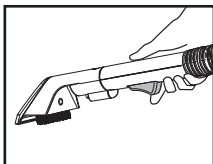
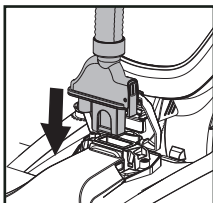

1. To connect the hose to the carpet cleaner flip up the hose connector cover cap. Press the hose connector onto the appliance connector, ensure it is securely attached.
2. Step on the on/off pedal to turn on the appliance.
3. While pulling the upholstery nozzle across the furniture press the lever on the upholstery nozzle to dispense cleaning solution. Release the lever when you reach the end of the upholstery.
4. Pull the nozzle over the same strip to suck the dirty water from the upholstery.
5. Continue in the same way as carpet cleaning (see cleaning the carpet section)
6. The water regulating knob can be used to control the water flow.



AFTER USE

- Empty both water tanks after each use.
- Allow the cleaned surfaces to dry completely. Do not stand on the carpet while it is still damp. Should you have to stand on the carpet, place white or colourfast towels down.
- Wipe away any cleaning solution that may have spilled onto wooden floors or furniture.
- When thoroughly dry, vacuum the carpet or upholstered furniture with a vacuum cleaner, preferably using a brush attachment.

CARE AND CLEANING

WARNING: The appliance **MUST** be switched off and unplugged from the mains outlet before cleaning or maintaining the appliance.

Cleaning the Water Tanks

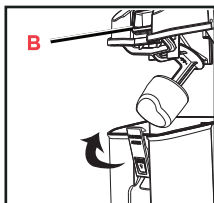
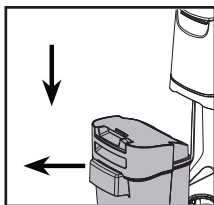

1. To empty the dirty water tank, press down the handle of the dirty water tank and pull it forwards out of the main unit.
2. To remove the dirty water tank lid pull the silicone cap of the dirty water tank **B** upwards.
3. Pour away the dirty water and rinse out the dirty water tank thoroughly with warm water.
4. Remove the clean water tank from the tank support and pour away any remaining cleaning solution. Rinse out the tank thoroughly with warm water.
5. Allow all parts to dry completely before reassembling them.
6. Insert the fresh water container back onto the appliance.
7. Replace the lid firmly onto the dirty water tank container and reattach the tank onto the main unit, make sure that the recess on the dirty water container fits in the frame of the main unit. Press the dirty water tank against the frame of the main unit until you hear it click.



CARE AND CLEANING

Cleaning the Suction Nozzle

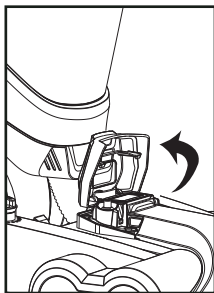

1. After every use clean the carpet suction nozzle. Flip up the hose connector cover cap. Grip the upper end of the carpet suction nozzle, pull it up and remove.
2. Rinse the carpet suction nozzle thoroughly with warm water.
3. Allow the carpet suction nozzle to dry completely before reattaching to the main unit. Place the locking lugs on the carpet suction nozzle into the recesses on the main unit and press down until a click is heard.

Cleaning the Roller Brushes

Note: Empty the clean and dirty water tanks before cleaning the roller brushes.

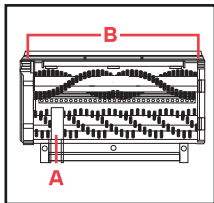

1. To remove the roller brushes for cleaning, lay the main unit on the floor so the bottom is accessible.
2. Remove belt cover **A**. Ease the belt off the drive pulley.
3. Press the release latches **B** and pull out the roller brush assembly.
4. Rinse the roller brushes thoroughly under warm running water.
5. Allow the roller brushes to dry thoroughly before re-fitting them into the main unit. Ensure they are located securely before securing the belt around the drive pulley and refitting the belt cover.

Replacing the Belt

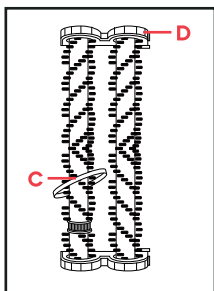

1. Follow the instructions above to remove the roller brushes.
2. Stand the roller brush assembly vertically with the belt pulley **C** to the bottom.
3. Remove the roller brush end cap **D**.
4. Slide the new belt onto the roller with the belt pulley **C** on it.
5. Replace the roller brush end cap **D**.



CARE AND CLEANING

6. Refit the roller brushes into the main unit, secure the new belt around the drive pulley and refit the belt cover.

Note: If you experience difficulties removing the roller brushes for cleaning or changing the belt. Contact Customer Service or check out our website for further information.

Cleaning the Upholstery Nozzle

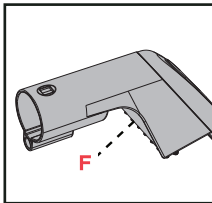
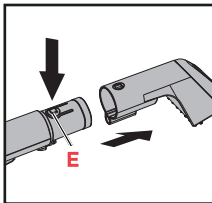

1. After each use clean the upholstery nozzle. Press the button on the base of the upholstery nozzle **E** and detach from the hose.
2. If necessary, remove the brush insert from the upholstery nozzle. Press down the button **F** on the bottom of the upholstery nozzle and pull out the brush insert.
3. Rinse the upholstery nozzle and brush insert thoroughly with warm water.
4. Allow all parts to dry completely before reassembling them.



TROUBLESHOOTING

Problem	Solution
No power or not switching on.	Check the fuse and try a new fuse with the same rating.
	Try a different appliance in the socket as it may be the socket that is at fault.
	The overheat protection may have activated. Unplug the appliance, leave to cool for approx 60 minutes before using again
No suction	Check the belt hasn't broken. Replace as necessary.
	Remove blockages from the upholstery hose
	Check the roller brushes for blockages
Burning smell.	Check the roller brushes for blockages and remove any blockages.
	Check the belt hasn't broken. Replace if needed.
Roller brushes not turning.	Check the roller brushes for blockages and remove any blockages.
	Check the belt hasn't broken. Replace if needed.
Carpet cleaner is hard to push.	Check the roller brushes are rotating. Remove any blockages and/or replace the belt as necessary.
Not removing stains.	The stain is too stubborn or old. Treat the stain directly with a carpet cleaning product.
Tripping electrics.	Try using a different socket.
	Ensure there are no other appliances being used on the same set of sockets as the vacuum.



SPARE PARTS

Part Number	Description	Qty per Product	Key Number
07147	Handle with water dispensing lever and upper cable hook	1	1
07148	Handle securing screw.	1	N/A
07149	Clean water tank with lid.	1	2 & 12
07150	Belt cover.	1	N/A
07151	Roller brush assembly.	1	9
07152	Dirty tank with lid and float	1	5
07153	Upholstery hose with connectors.	1	19
07154	Upholstery nozzle.	1	20
07155	Belt.	1	N/A





CONTACT US

If you are having a problem with your appliance, please contact our Helpline, as we are more likely to be able to help than the store you purchased the item from. Please have the product name, model number and serial number to hand when you contact us to help us deal with your enquiry quicker.

email: hello@morphyrichards.co.uk

www: www.morphyrichards.co.uk

PRODUCT RECYCLING



For electrical products sold within the European Community, at the end of the electrical products useful life, it should not be disposed of with household waste.

Please recycle where facilities exist.

Check with your Local Authority or retailer for recycling advice in your country.





NOTES

[illegible]



REGISTERING YOUR 3 YEAR GUARANTEE

Your standard 2 year guarantee is extended for an additional 1 year when you register the product within 28 days of purchase with Morphy Richards. If you do not register the product with Morphy Richards within 28 days, your product is guaranteed for 2 years.



**To validate your 3 year guarantee,
scan the QR code or register online
at www.morphyrichards.co.uk**

N.B. Each qualifying product needs to be registered with Morphy Richards individually. Please note that the 2 year guarantee is only available in the UK. Please refer to the 2 year guarantee for more information.

YOUR 2 YEAR GUARANTEE

It is important to retain the retailer's receipt as proof of purchase. Staple your receipt to the back cover for future reference.

Please quote the following information if the product develops a fault. These numbers can be found on the base of the product.

Model no.

Serial no.

All Morphy Richards products are individually tested before leaving the factory. In the unlikely event of any appliance proving to be faulty within 28 days of purchase, it should be returned to the place of purchase for it to be replaced. If the fault develops after 28 days and within 24 months of original purchase, you should contact the Helpline quoting Model number and Serial number on the product, or write to Morphy Richards at the address shown. You may be asked to return a copy of proof of purchase.

Subject to the exclusions set out on the next page (see Exclusions), the faulty appliance will then be repaired or replaced as appropriate and dispatched usually within 7 working days of receipt.

If, for any reason, this item is replaced or repaired during the 2 year



REGISTERING YOUR 3 YEAR GUARANTEE

guarantee period, the guarantee on the new item will be calculated from the original purchase date. Therefore it is vital to retain your original till receipt or invoice to indicate the date of initial purchase.

To qualify for the 2 year guarantee, the appliance must have been used according to the instructions supplied.

The appliance is intended for domestic use only. Misuse or use for commercial or any other purpose will render the guarantee invalid.

Exclusions

Morphy Richards shall not be liable to replace or repair the goods under the terms of the guarantee where:

1. The fault has been caused or is attributable to accidental use, misuse, negligent use or used contrary to the manufacturer's recommendations or where the fault has been caused by power surges or damage caused in transit.
2. The appliance has been used on a voltage supply other than that stamped on the products.
3. Repairs have been attempted by persons other than our service staff (or authorised dealer).
4. The appliance has been used for hire purposes or non domestic use.
5. The appliance is second hand or refurbished.
6. Morphy Richards reserves the right not to carry out any type of servicing under the guarantee at its discretion.

This guarantee does not confer any rights other than those expressly set out above and does not cover any claims for consequential loss or damage. This guarantee is offered as an additional benefit and does not affect your statutory rights as a consumer. Morphy Richards products are intended for household use only. See usage limitations within the location safety instructions.

Disclaimer

Morphy Richards has a policy of continuous improvement in product quality and design. The company, therefore reserves the right to change the specification of its models at any time.



VC741000MUK Rev1

morphy richards



@morphyrichardsuk #loveyourmorphy

morphyrichards.co.uk

Morphy Richards

9 Cabot Lane, Poole, Dorset, BH17 7BY, UK

