



# morphy richards

**3 Year  
Guarantee\***

\*Upon registering your product  
at [morphyrichards.co.uk](http://morphyrichards.co.uk)

SIGNATURE

1.5L Jug Kettle



Model No.

100703/100704/

100705/100742/

100744

## User Manual

Please read and keep these instructions for future use



## HEALTH AND SAFETY

The use of any electrical appliance requires the following common sense safety rules.

**Please read these instructions carefully before using the product.**

- This appliance can be used by children aged from 8 years and above and persons with reduced physical, sensory or mental capabilities, or lack of experience and knowledge, if they have been given supervision or instruction concerning the use of the appliance in a safe way and understand the hazards involved.
- Children shall not play with the appliance.
- Cleaning and user maintenance shall not be made by children without supervision.
- If the mains cable is damaged, it must be replaced by the manufacturer, its service agent or similarly qualified person in order to avoid a hazard.
- **WARNING: Do not open the lid whilst the water is boiling.**



## HEALTH AND SAFETY

- **WARNING: Misuse of the appliance could cause personal injury.**
- **WARNING: Avoid spillage on the connector.**
- This appliance has an element which may be subject to residual heat after use.
- Keep the appliance and its cord out of reach of children.
- This appliance is intended for household use only. It is not suitable for use in staff kitchen areas in shops, offices and other commercial environments.
- This appliance is not intended to be operated on an extension cable or by means of an external timer or a separate remote control system.



## HEALTH AND SAFETY

### LOCATION

- Always locate your appliance away from the edge of the worktop.
- Ensure that the appliance is used on a firm, flat surface.
- Do not use the appliance outdoors or near water.
- **WARNING! Do not place the appliance onto a metal tray or metal surface whilst in use.**

### MAINS CABLE

- Do not let the mains cable hang over the edge of the worktop where a child could reach it.
- Do not let the mains cable run across an open space e.g. between a low socket and a table.
- Do not let the mains cable run across a cooker or other hot area which might damage the cable.
- The mains cable should reach from the socket to the base unit without straining the connections.

### PERSONAL SAFETY

- Always keep the top of the cordless base dry, especially around the connection area, disconnect the power supply before drying. Allow to dry thoroughly before reconnection to the power supply.
- Do not move the kettle while switched on.

- Always pour hot water slowly and carefully without tipping the appliance too fast to prevent splashing and spillage.
- Do not hold the switch in the on position or tamper with the switch to fix it in the on position as this may cause damage to the switch-off mechanism.
- Do not fill above the MAX mark, otherwise boiling water may be ejected.

### OTHER SAFETY CONSIDERATIONS

- Do not use attachments or tools not recommended by Morphy Richards as this may cause fire, electric shock or injury.
- This kettle is only to be used with the stand provided.
- Do not use the appliance for any use other than to boil water.
- The appliance must not be on the base unit when being filled with water.
- Unplug from the outlet when not in use.
- **WARNING! The appliance must not be immersed for cleaning.**



## HEALTH AND SAFETY



**CAUTION!  
HOT  
SURFACE!**

### TREATING SCALDS

- Run cold water over the affected area immediately.
- Do not stop to remove clothing.
- Get medical help quickly.

## ELECTRICAL REQUIREMENTS

Check that the voltage on the rating plate of your appliance corresponds with your house electricity supply which must be A.C. (Alternating Current).

**WARNING: The plug removed from the mains lead, if severed, must be destroyed, as a plug with a bared flexible cord is hazardous if engaged into a live socket outlet.**

Should the fuse in the mains plug require changing, replace it with a fuse of the same rating as originally fitted.

**WARNING: This appliance must be earthed.**



## PRODUCT OVERVIEW

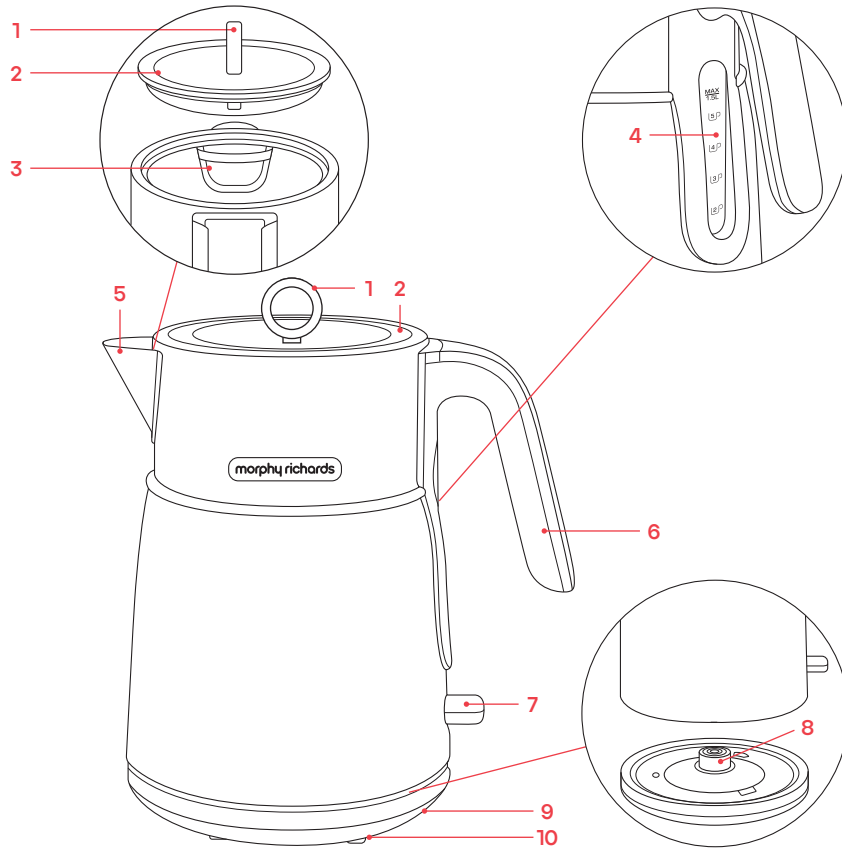

- |                               |                               |
|-------------------------------|-------------------------------|
| 1. Lid pull handle            | 6. Handle                     |
| 2. Lid                        | 7. On/off switch              |
| 3. Removable limescale filter | 8. 360° connector             |
| 4. Water gauge                | 9. Cordless power base        |
| 5. Spout                      | 10. Cord storage (underneath) |

## BEFORE FIRST USE

Before using the appliance for the first time, fill with water, boil and pour away.





## USING YOUR KETTLE

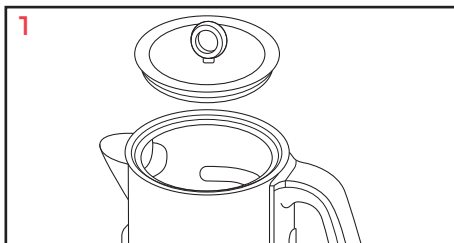

Using the lid pull handle (1), remove the lid (2).

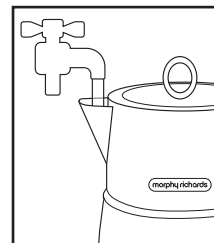
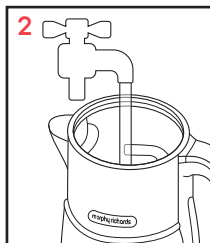

Fill the kettle with water, through the lid opening, or alternatively fill through the spout (5) without removing the lid.

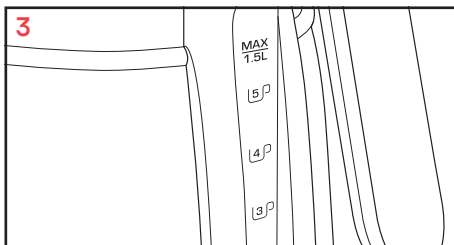

**IMPORTANT! Do not fill to below the minimum fill line on the inside of the kettle, or above the max line on the water gauge.**

To help to protect the environment, only boil as much water as you need. Ensure the lid is placed back on correctly.

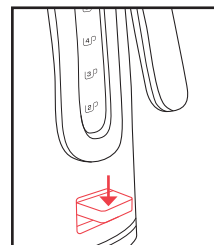
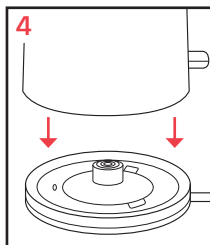

Place the kettle on the cordless power base (9) and press the on/off switch (7). The on/off switch will illuminate.

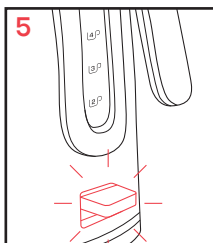

When boiled, the kettle will automatically switch off. Remove from the cordless power base (9).

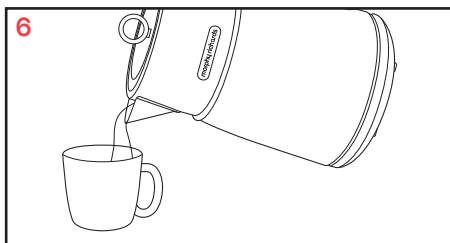
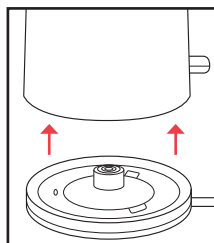

Pour the water from the kettle.

**WARNING! When boiled, allow a few seconds before pouring. Both the kettle and water will be hot.**





## CLEANING YOUR KETTLE

- **WARNING!** Always disconnect the plug from the mains and allow the kettle to cool before cleaning.
- Wipe the outside with a damp cloth.
- **IMPORTANT!** Do not use abrasive cleaners on the outside of the kettle which may scratch the surface.

## REMOVING THE FILTER

1. Allow the kettle to cool completely before removing the filter.
2. Using the lid pull handle (1), remove the lid (2).
3. Pull the removable limescale filter (3) from inside the kettle.
4. To refit the filter (3), slide it into the support moulding and push to lock it.

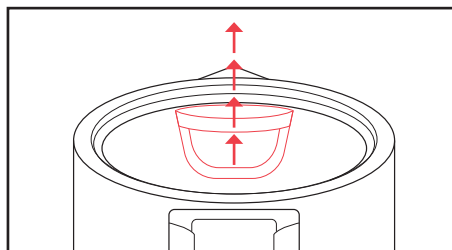

**WARNING!** Never boil the kettle with the removable limescale filter removed. It must be attached to the kettle at all times.

## DESCALING

- **IMPORTANT!** As this appliance is fitted with a concealed element it must be descaled regularly. The frequency of descaling depends on usage and the hardness of the water in your area.
- Excessive scale can cause the appliance to switch off before boiling and may damage the element, invalidating the warranty.
- It is essential that regular descaling takes place. We recommend descaling your kettle every month.







## DESCALING

- Remove hard scale using a proprietary descaling product suitable for stainless steel, glass or plastic. Please follow the cleaning products instructions carefully.
- **IMPORTANT! Ensure that the electrical connections are completely dry before using the appliance.**

## CONTACT US

If you are having a problem with your appliance, please contact our Helpline, as we are more likely to be able to help than the store you purchased the item from. Please have the product name, model number and serial number to hand when you contact us to help us deal with your enquiry quicker.

email: [hello@morphyrichards.co.uk](mailto:hello@morphyrichards.co.uk)

[www.morphyrichards.co.uk](http://www.morphyrichards.co.uk)

## PRODUCT RECYCLING



For electrical products sold within the European Community, at the end of the electrical products useful life, it should not be disposed of with household waste.

Please recycle where facilities exist.

Check with your Local Authority or retailer for recycling advice in your country.



## REGISTERING YOUR 3 YEAR GUARANTEE

Your standard 2 year guarantee is extended for an additional 1 year when you register the product within 28 days of purchase with Morphy Richards. If you do not register the product with Morphy Richards within 28 days, your product is guaranteed for 2 years.



To validate your 3 year guarantee,  
scan the QR code or register online  
at [www.morphyrichards.co.uk](http://www.morphyrichards.co.uk)

N.B. Each qualifying product needs to be registered with Morphy Richards individually. Please note that the 2 year guarantee is only available in the UK. Please refer to the 2 year guarantee for more information.

## YOUR 2 YEAR GUARANTEE

It is important to retain the retailer's receipt as proof of purchase. Staple your receipt to the back cover for future reference.

Please quote the following information if the product develops a fault. These numbers can be found on the base of the product.

**Model no.**

**Serial no.**

All Morphy Richards products are individually tested before leaving the factory. In the unlikely event of any appliance proving to be faulty within 28 days of purchase, it should be returned to the place of purchase for it to be replaced. If the fault develops after 28 days and within 24 months of original purchase, you should contact the Helpline quoting Model number and Serial number on the product, or write to Morphy Richards at the address shown. You may be asked to return a copy of proof of purchase.

Subject to the exclusions set out below (see Exclusions), the faulty appliance will then be repaired or replaced as appropriate and dispatched usually within 7 working days of receipt.

If, for any reason, this item is replaced or repaired during the 2 year





## REGISTERING YOUR 3 YEAR GUARANTEE

guarantee period, the guarantee on the new item will be calculated from the original purchase date. Therefore it is vital to retain your original till receipt or invoice to indicate the date of initial purchase.

To qualify for the 2 year guarantee, the appliance must have been used according to the instructions supplied.

The appliance is intended for domestic use only. Misuse or use for commercial or any other purpose will render the guarantee invalid.

### Exclusions

Morphy Richards shall not be liable to replace or repair the goods under the terms of the guarantee where:

1. The fault has been caused or is attributable to accidental use, misuse, negligent use or used contrary to the manufacturer's recommendations or where the fault has been caused by power surges or damage caused in transit.
2. The appliance has been used on a voltage supply other than that stamped on the products.
3. Repairs have been attempted by persons other than our service staff (or authorised dealer).
4. The appliance has been used for hire purposes or non domestic use.
5. The appliance is second hand or refurbished.
6. Morphy Richards reserves the right not to carry out any type of servicing under the guarantee at its discretion.

This guarantee does not confer any rights other than those expressly set out above and does not cover any claims for consequential loss or damage. This guarantee is offered as an additional benefit and does not affect your statutory rights as a consumer. Morphy Richards products are intended for household use only. See usage limitations within the location safety instructions.

### Disclaimer

Morphy Richards has a policy of continuous improvement in product quality and design. The company, therefore reserves the right to change the specification of its models at any time.



KT100742MUK Rev4

# morphy richards



@morphyrichardsuk #loveyourmorphy

[morphyrichards.co.uk](https://www.morphyrichards.co.uk)

**Morphy Richards**

9 Cabot Lane, Poole, Dorset, BH17 7BY, UK

