



morphy richards

3 Year
Guarantee*

*Upon registering your product
at morphyrichards.co.uk

0.9 LITRE
Dehumidifier



Model No.

822000
822001

User Manual

Please read and keep these instructions for future use





HEALTH AND SAFETY

The use of any electrical appliance requires the following common sense safety rules.

Please read these instructions carefully before using the product.

- **WARNING:** Disconnect from the mains supply before carrying out any routine maintenance.
- **WARNING:** Misuse of the appliance could cause personal injury.
- This appliance can be used by children aged from 8 years and above and persons with reduced physical, sensory or mental capabilities, or lack of experience and knowledge, if they have been given supervision or instruction concerning the use of the appliance in a safe way and understand the hazards involved.
- Children shall not play with the appliance.
- Cleaning and user maintenance shall not be made by children unless they are older than 8 years and supervised.





HEALTH AND SAFETY

- Keep the appliance and its cord out of reach of children less than 8 years.
- Do not use in an inflammable or explosive environment or which is above 40°C. Ideal operating environment temperature is 8°C - 40°C. Low temperatures may reduce dehumidification efficiency.
- The appliance is not intended to be operated on an extension cable or by means of an external timer or separate remote control system.
- This appliance is intended for indoor household use only. It is not suitable for use in staff kitchen areas in shops, offices and other commercial environments.



HEALTH AND SAFETY

MAINS CABLE

- The appliance should only be used with the adapter supplied.
 - Do not let the adapter cable run across an open space e.g. between a low socket and a table.
 - Do not place the cable in a position where it can be pulled by children or animals or tripped over.
 - The adapter cable should reach from the socket to the product without straining the connections.
 - It is normal that the adapter will get hot during use.
- damage the appliance.
 - In the unlikely event technical problems develop, stop using the product immediately and seek advice from the manufacturer.
 - **WARNING:** Do not wrap the adapter cable around the main body of the appliance during or after use.

PERSONAL SAFETY

- Do not allow water or other liquids to run into the appliance as it could create a fire/electrical hazard. Do not operate with wet hands.
- Dispose of water collected from the dehumidifier. This water is not drinkable.
- Do not touch the adapter cable or plug with wet hands.
- Do not pull the adapter cable when unplugging.
- Keep hands, hair and clothing away from the appliance while in operation, to prevent personal injury and/or damage to the appliance.
- Do not push any objects in to the air inlet or outlet grilles as this may cause electric shock, fire or

OTHER SAFETY CONSIDERATIONS

- Only use for its intended purpose.
- Do not in any way obstruct the air inlets and outlets of the appliance.
- Do not attempt to repair or adjust any electrical or mechanical element of the appliance. Doing so may be unsafe and will void your warranty.

LOCATION

- Ensure that the appliance is used on a firm flat surface.
- The appliance **MUST** have a minimum clearance of 50cm around all sides.
- Do not cover or place any objects on the dehumidifier.
- Do not use this appliance near water or in the immediate surroundings of a bath, shower or swimming pool.
- Do not use outdoors, this appliance is intended for indoor household use only.



ELECTRICAL DETAILS

Check that the voltage on the rating plate of your appliance corresponds with your house electricity supply which must be A.C. (Alternating Current).

Should the fuse in the mains plug require changing, replace it with a fuse of the same rating as originally fitted.

WARNING: The plug removed from the mains lead, if severed, must be destroyed, as a plug with a bared flexible cord is hazardous if engaged into a live socket outlet.

WARNING: This appliance must be earthed.

The power consumption in off mode into which the equipment is switched automatically is 0.21w. The time is permanent when connected to the power source.



PRODUCT OVERVIEW



- | | |
|---|---|
| 1. Control Panel | 6. Ambience Light Selector Button and LED |
| 2. Air Inlet | 7. Defrost Mode Indicator Light |
| 3. Air Outlet | 8. Charger Port (at the back of dehumidifier) |
| 4. Water Tank (removable lid not shown) | |
| 5. Power ON/OFF Button and LED | |





INTENDED USE

Your Morphy Richards 900ml Dehumidifier is ideal for use in small bedroom areas, wardrobes, small kitchen, closet, caravan, window sills, drying damp walls, mobile homes.

This appliance is intended for indoor household use only.

BEFORE FIRST USE

- Remove all packaging and ensure that all parts are included and undamaged prior to use.
- Ensure that the dehumidifier is assembled correctly.



USING YOUR DEHUMIDIFIER

1. Attach the adapter to the dehumidifier and plug into the mains outlet, the appliance will enter standby mode.
2. Press the Power ON/OFF button (5), the appliance will beep once, the Power ON/OFF LED the Ambience LED (6) and the Ambience light in the water tank will illuminate.
3. The Ambience light in the water tank will cycle through 7 colours, to lock on a colour, press the Ambience Light Selector Button (6) a beep will be heard. To turn off the Ambience light press the button again, the Ambience LED (6) will go out. Press again to turn it back on.
4. To turn off the appliance, press Power ON/OFF button (5), a beep will be heard.
5. When the water tank is full, the ambience light in the water tank will illuminate red, 3 beeps will be heard and the dehumidifier will stop working. See emptying the water tank section.

DEFROST MODE

1. Defrost mode will automatically activate in cold temperatures such as winter, the Defrost Mode Indicator Light (7) will illuminate.
2. Switch off the dehumidifier and wait for it to defrost or move it to a warmer area to speed up defrosting.





EMPTYING THE WATER TANK

1. Before emptying the water tank, the dehumidifier **MUST** be switched off and the adapter disconnected from the mains outlet.

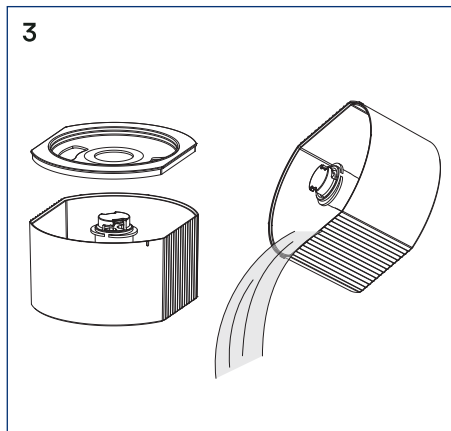
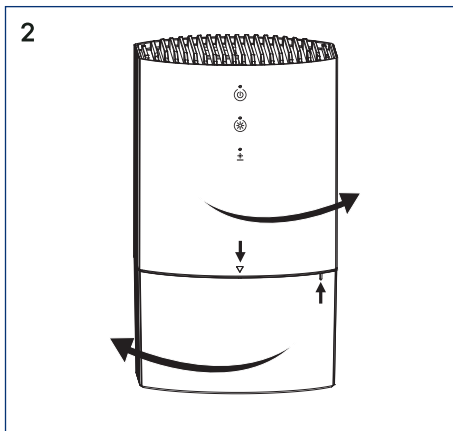

2. Hold the water tank with one hand and rotate the upper assembly anti-clockwise and lift away the upper assembly.
3. Remove the water tank lid and pour away the water.
4. Replace the water tank lid, refit the upper assembly to the water tank and rotate clockwise until the markers are aligned above the water tank window.

CARE & CLEANING

Before cleaning and maintaining, the dehumidifier **MUST** be switched off and the adapter disconnected from the mains outlet.

Do not immerse the appliance in water.

1. To clean the main body, wipe with a soft, damp cloth with a mild detergent. Do not use acidic or alkaline solvents.
2. Ensure the appliance is dried thoroughly before using again.



STORAGE

- Ensure the appliance and Water Tank are clean and dry before storing.
- To store your product out of season we recommend using the original box or similar size box.
- Unplug the adapter from the appliance and store separately, do not wrap the cable around the appliance as this cause damage to the adapter and cable.
- Store in a safe, clean and dry place when not in use.





TROUBLESHOOTING

Problem	Solution
Not working.	Try a different appliance in the socket as it may be the socket that is at fault.
	The water tank may not be fitted correctly. Refit the water tank.
	The water tank may be full of water. Empty the water tank.
	The ambient humidity doesn't reach the products operating level.
	The dehumidifier may not been on a firm, level surface. Relocate the appliance.
Appliance collects water slowly or not at all.	The air inlet and outlet may be covered or obstructed. Check for and move any coverings or obstructions.
	Doors and/or windows may be open. Close them.
	The dehumidification capacity will be affected in temperature below 20°C and humidity below 40%.
	Low ambient temperature has caused defrost mode to activate. Switch of the appliance and wait for it to defrost or move to a warmer area to speed up defrosting.
	Check there are no other dehumidifying devices in the room.
Appliance doesn't stop when the tank is full.	Float may be stuck, switch off the appliance and check the float.
	Water tank may not be installed properly, switch off the appliance and refit the water tank
Water tank constantly shows red light alarm.	Empty the water tank.
	Water tank lid isn't fitted properly. Switch the appliance off and refit the water tank lid.



SPARE PARTS

Part Number	Description	Quantity per Product	Key Number
33027	Water tank lid	1	N/A
33028	Water tank assembly with float White (model 822000)	1	4
33029	Water tank assembly with float Grey (model 822001)	1	4
33030	Adapter White (model 822000)	1	N/A
33031	Adapter Black (model 822001)	1	N/A



CONTACT US

If you are having a problem with your appliance, please contact our Helpline, as we are more likely to be able to help than the store you purchased the item from. Please have the product name, model number and serial number to hand when you contact us to help us deal with your enquiry quicker.

email: hello@morphyrichards.co.uk

www.morphyrichards.co.uk

PRODUCT RECYCLING



For electrical products sold within the European Community, at the end of the electrical products useful life, it should not be disposed of with household waste.

Please recycle where facilities exist.

Check with your Local Authority or retailer for recycling advice in your country.





REGISTERING YOUR 3 YEAR GUARANTEE

Your standard 2 year guarantee is extended for an additional 1 year when you register the product within 28 days of purchase with Morphy Richards. If you do not register the product with Morphy Richards within 28 days, your product is guaranteed for 2 years.



**To validate your 3 year guarantee,
scan the QR code or register online
at www.morphyrichards.co.uk**

N.B. Each qualifying product needs to be registered with Morphy Richards individually. Please note that the 2 year guarantee is only available in the UK. Please refer to the 2 year guarantee for more information.

YOUR 2 YEAR GUARANTEE

It is important to retain the retailer's receipt as proof of purchase. Staple your receipt to the back cover for future reference.

Please quote the following information if the product develops a fault. These numbers can be found on the base of the product.

Model no.

Serial no.

All Morphy Richards products are individually tested before leaving the factory. In the unlikely event of any appliance proving to be faulty within 28 days of purchase, it should be returned to the place of purchase for it to be replaced. If the fault develops after 28 days and within 24 months of original purchase, you should contact the Helpline quoting Model number and Serial number on the product, or write to Morphy Richards at the address shown. You may be asked to return a copy of proof of purchase.

Subject to the exclusions set out on the next page (see Exclusions), the faulty appliance will then be repaired or replaced as appropriate and dispatched usually within 7 working days of receipt.

If, for any reason, this item is replaced or repaired during the 2 year





REGISTERING YOUR 3 YEAR GUARANTEE

guarantee period, the guarantee on the new item will be calculated from the original purchase date. Therefore it is vital to retain your original till receipt or invoice to indicate the date of initial purchase.

To qualify for the 2 year guarantee, the appliance must have been used according to the instructions supplied.

The appliance is intended for domestic use only. Misuse or use for commercial or any other purpose will render the guarantee invalid.

Exclusions

Morphy Richards shall not be liable to replace or repair the goods under the terms of the guarantee where:

1. The fault has been caused or is attributable to accidental use, misuse, negligent use or used contrary to the manufacturer's recommendations or where the fault has been caused by power surges or damage caused in transit.
2. The appliance has been used on a voltage supply other than that stamped on the products.
3. Repairs have been attempted by persons other than our service staff (or authorised dealer).
4. The appliance has been used for hire purposes or non domestic use.
5. The appliance is second hand or refurbished.
6. Morphy Richards reserves the right not to carry out any type of servicing under the guarantee at its discretion.

This guarantee does not confer any rights other than those expressly set out above and does not cover any claims for consequential loss or damage. This guarantee is offered as an additional benefit and does not affect your statutory rights as a consumer. Morphy Richards products are intended for household use only. See usage limitations within the location safety instructions.

Disclaimer

Morphy Richards has a policy of continuous improvement in product quality and design. The company, therefore reserves the right to change the specification of its models at any time.



AT822000MUK Rev1

morphy richards

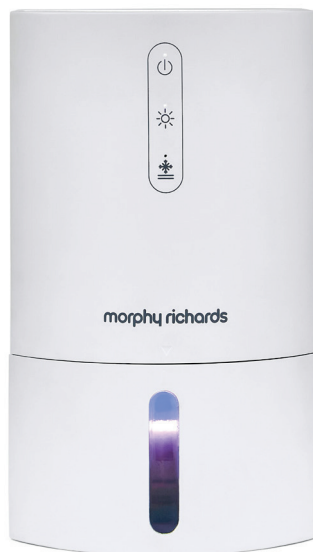

@morphyrichardsuk #loveyourmorphy

[morphyrichards.co.uk](https://www.morphyrichards.co.uk)

Morphy Richards

9 Cabot Lane, Poole, Dorset, BH17 7BY, UK

