

FP46718 MUK Rev 3

morphyrichards®

smart ideas for your home



Multifunction Opener

 Please read and keep these instructions for future use

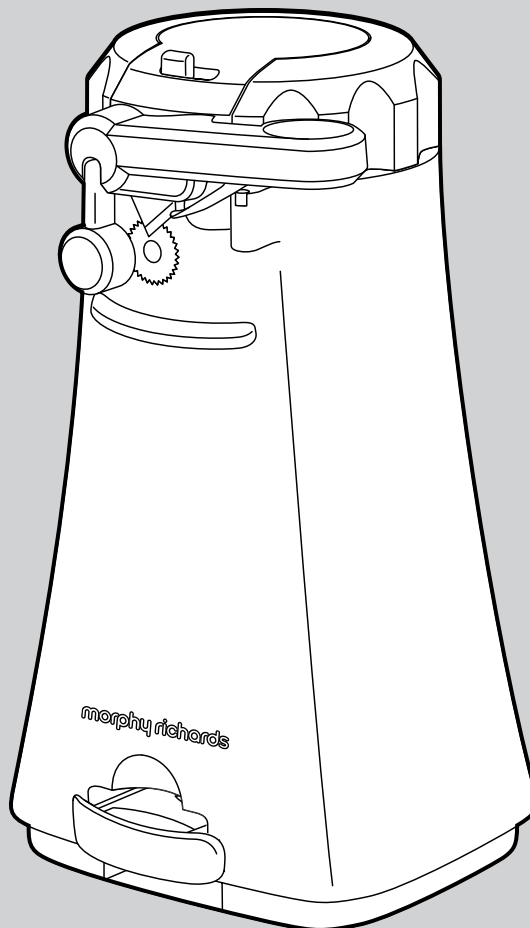

For competitions, product hints and tips and more join us at



www.morphyrichards.co.uk/blog



www.facebook.com/morphyrichardsuk



[@loveyourmorphyrichards](https://twitter.com/loveyourmorphyrichards)

www.morphyrichards.com

* Register online for your 2 year guarantee. See the back of this instruction book for details (UK and Ireland customers only).

Health and Safety

The use of any electrical appliance requires the following common sense safety rules. Please read these instructions carefully before using the product.

- This appliance can be used by children aged from 8 years and above if they have been given supervision or instruction concerning the use of the appliance in a safe way and understand the hazards involved. Cleaning and user maintenance shall not be made by children unless they are aged from 8 years and above and supervised. Keep the appliance and its cord out of the reach of children aged less than 8 years.
- Appliances can be used by persons with reduced physical, sensory or mental capabilities or lack of experience and knowledge if they have been given supervision or instruction concerning use of the appliance in a safe way and if they understand the hazards involved.
- Children shall not play with the appliance.
- If the mains cable is damaged, it must be replaced by the manufacturer, it's service agent or similarly qualified person in order to avoid a hazard.
- Avoid touching moving parts. Keep hands, hair and clothing away from the blade during operation, to prevent personal injury and/or damage to the appliance.
- Unplug from the outlet when not in use, or when left unattended, and before assembling, disassembling or cleaning.
- **WARNING:** The blades are very sharp. Handle with care when using and cleaning. For cleaning refer to page 6.

Location

- Ensure the appliance is used on a firm, flat surface.
- Do not use the appliance outdoors or near water.
- Do not place the appliance on or near hot surfaces such as a hot plate, radiant rings or near a naked flame.
- **WARNING:** Do not place the Multifunction Opener onto a metal tray or metal surface whilst in use.

Mains cable

- Do not let the mains cable hang over the edge of the worktop where a child could reach it.
- Do not let the lead run across an open space e.g. between a low socket and a table.
- Do not let the cable run across a cooker or other hot area which might damage the cable.
- The mains cable should reach from the socket to the base unit without straining the connections.

Personal safety

- **WARNING:** To protect against the risk of electric shock, NEVER immerse the appliance body in water or in any other liquid and always ensure the electrical connections are kept dry.

Other safety considerations

- Do not operate any appliance with a damaged cord or plug or after the appliance malfunctions or has been damaged in any manner.
- The use of attachments or tools not recommended or sold by Morphy Richards may cause fire, electric shock or injury.
- Do not use the appliance for anything other than it's intended purpose.

Product specific safety

- **WARNING:** To protect against fire, electric shock and personal injury, do not immerse the cord, plug or appliance body in water or other liquid.
- Do not clean the attachments under running water while they are in position.
- Make sure the can opener is not loaded before connecting to or disconnecting from the mains supply and when left unattended.

Electrical requirements

Check that the voltage on the rating plate of your appliance corresponds with your house electricity supply which must be A.C. (Alternating Current). Should the fuse in the 13 amp plug require changing, a 3 amp BS1362 fuse must be fitted.

Product overview

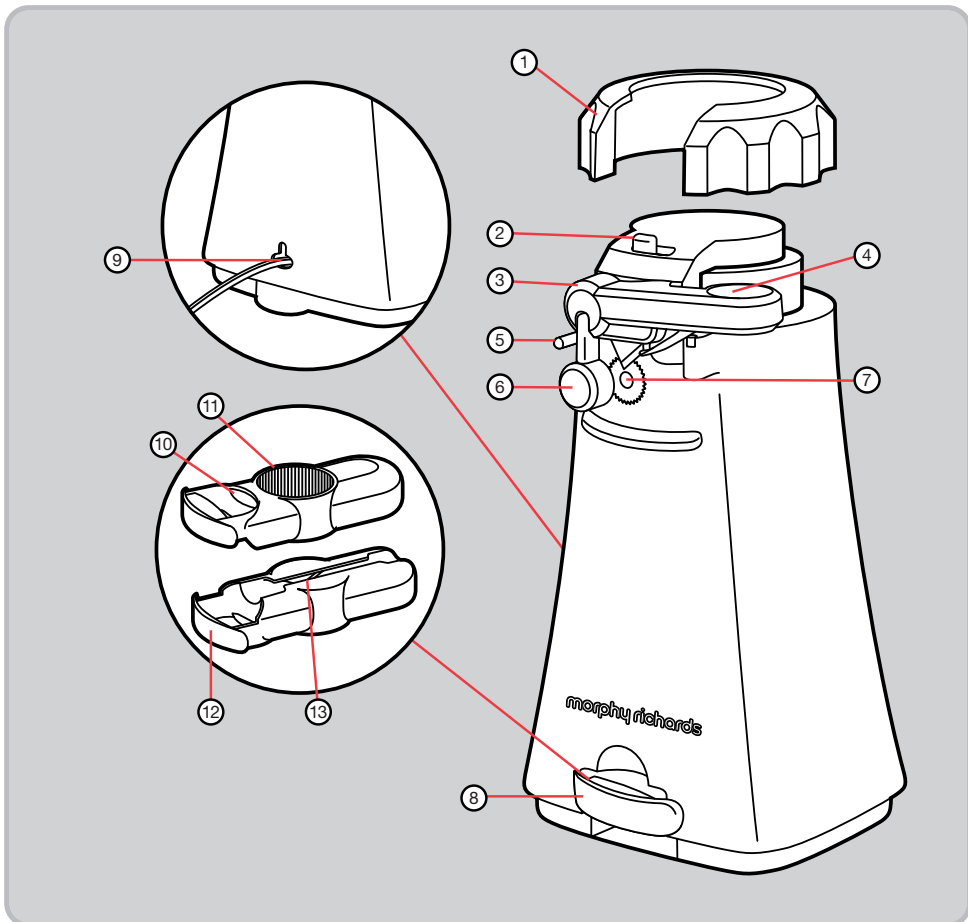

Features

- | | |
|------------------------------|---|
| (1) Grip & Grab Tool | (11) Twist Cap Bottle Opener |
| (2) Cutting Release Button | (12) Ring Pull Can Opener |
| (3) Cutting Assembly | (13) Cutting Blade
(For plastic packaging) |
| (4) Cutting Lever | |
| (5) Guide Pin | |
| (6) Magnetic Lid Holder | |
| (7) Geared Wheel | |
| (8) Multi Tool | |
| (9) Cord Storage | |
| (10) Metal Cap Bottle Opener | |

Using your multifunction opener

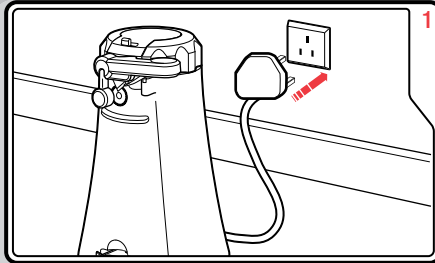

Plug the multifunction opener into a mains outlet.

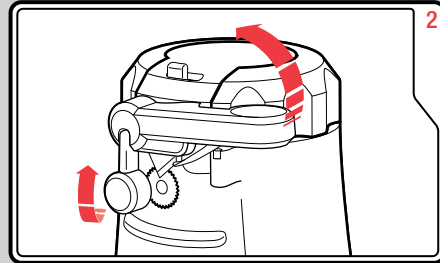

Raise the Magnetic Lid Holder (6) up and lift the Cutting Lever (4).

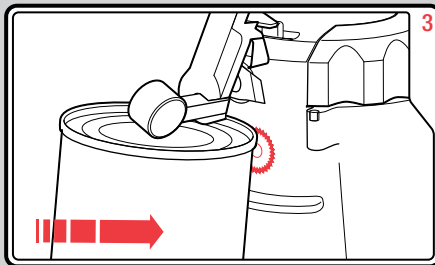

Move the unopened can into place. Position the rim of the can below the Guide Pin (5) and on top of the Geared Wheel (7).



Lower the opening mechanism into place, pressing down on the Cutting Lever (4). The Magnetic Lid Holder (6) will connect to the lid and the multifunction opener will start automatically.

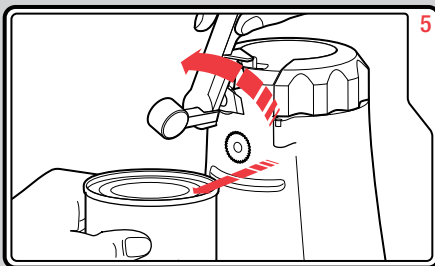

When the can has stopped moving, hold the opened can and lift the Cutting Lever to release the can.

Notes:

- The motor will automatically stop when the can is open.
- It is not necessary to hold the lever down or hold the can while it is being opened.
- If there is a bump, dent, or heavy seam in the rim of the can, open the other end of the can or start the cutter just beyond it.
- The motor of the can opener is permanently lubricated and will require no oiling.
- Do not place the appliance on a highly polished wooden surface as damage may occur to the surface.

Using your Grip & Grab Tool and Multi Tool

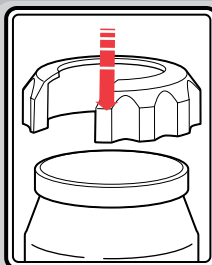

Grip & Grab Tool
(fits multiple jar sizes)

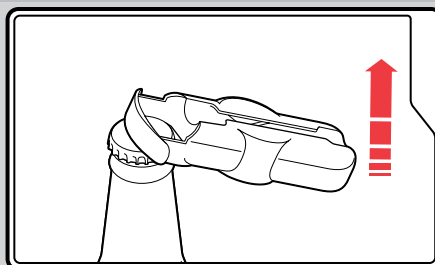
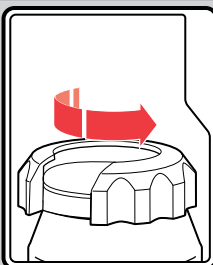

Multi Tool: Metal Cap Bottle Opener

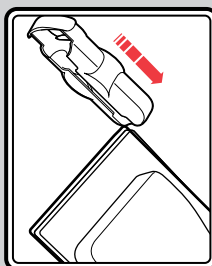

Multi Tool: Cutting Blade
(for plastic blister packaging)

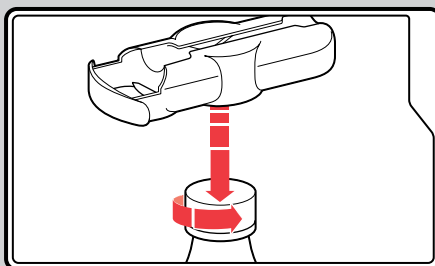
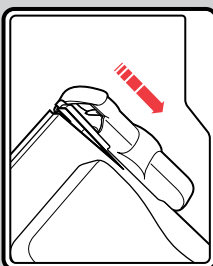

Multi Tool: Twist Cap Bottle Opener
(for plastic bottles)

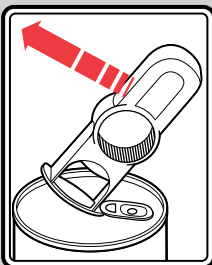

Multi Tool: Ring Pull Can Opener



WARNING

MULTI TOOL CONTAINS A SHARP BLADE. USE CARE WHEN HOLDING OR HANDLING THE MULTI TOOL.

WARNING: ELECTRICAL SHOCK HAZARD
DO NOT IMMERSE THE MULTIFUNCTION OPENER BODY OR CORD IN WATER OR ANY OTHER LIQUID.

Care & cleaning

- To avoid damaging your can opener, do not use abrasive cleaners or scouring pads.

Cleaning your multifunction opener

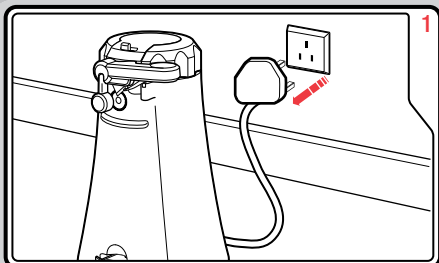

Unplug the multifunction opener from the mains.

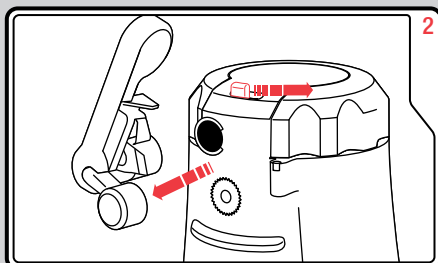

Slide the Cutting Release Button (2) and remove the Cutting Assembly (3) from the Main Unit.

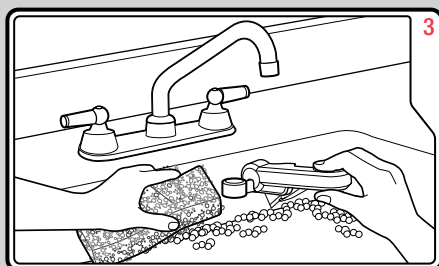

Clean the Cutting Assembly with warm soapy water.

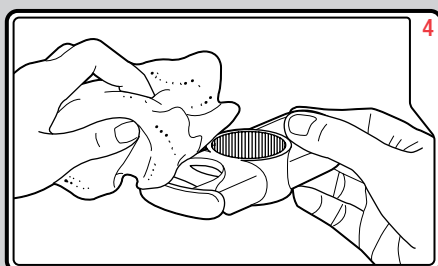

Clean the Multi Tool (8) and Grip & Grab Tool (1) with a damp cloth.

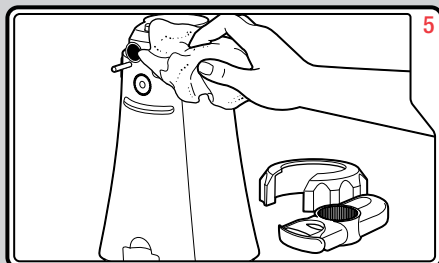

Clean the main unit with a damp cloth.
DO NOT IMMERSE IN WATER

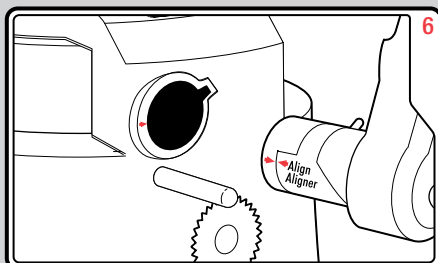

Align the alignment arrows on the Cutting Assembly (3) and Main Unit.

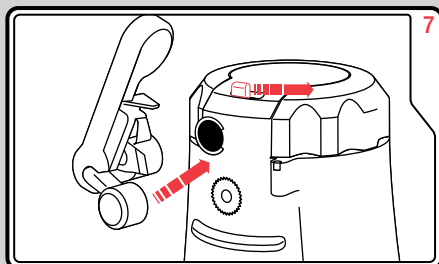

Slide the Cutting Release Button (2) and replace the Cutting Assembly into the main unit.

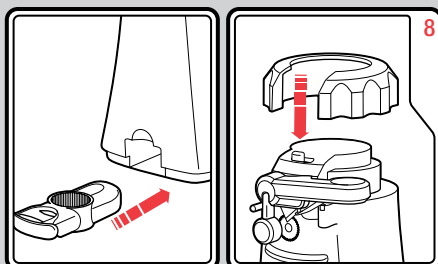

Replace the Multi Tool (1) and Grip & Grab Tool (8) onto the main unit for storage.

Contact us

Helpline

If you are having a problem with your appliance, please call our Helpline, as we are more likely to be able to help than the store you purchased the item from.

Please have the product name, model number and serial number to hand when you call to help us deal with your enquiry quicker.

UK Helpline: 0344 871 0944

IRE Helpline: 1800 409 119

Spares: 0344 873 0710

Talk To Us

If you have any questions or comments, or want some great tips or recipe ideas to help you get the most out of your products, join us online:

Blog: www.morphyrichards.co.uk/blog

Facebook: www.facebook.com/morphyrichardsuk

Twitter: www.twitter.com/loveyourmorphyrichards

Website: www.morphyrichards.com

FP46718 MUK Rev 3 01/15

Registering your 2 year guarantee

Your standard one year guarantee is extended for an additional 12 months when you register the product within 28 days of purchase with Morphy Richards. If you do not register the product with Morphy Richards within 28 days, your product is guaranteed for 1 year. To validate your 2 year guarantee register with us online at

www.morphyrichards.co.uk

Or call our customer registration line

UK 0344 871 0242

IRE 1800 409 119

N.B. Each qualifying product needs to be registered with Morphy Richards individually.

Please note that the 2 year guarantee is only available in the UK and Ireland. Please refer to the one year guarantee for more information.

Your 1 year guarantee

It is important to retain the retailer's receipt as proof of purchase. Staple your receipt to this back cover for future reference.

Please quote the following information if the product develops a fault. These numbers can be found on the base of the product.

Model no.

Serial no.

All Morphy Richards products are individually tested before leaving the factory. In the unlikely event of any appliance proving to be faulty within 28 days of purchase, it should be returned to the place of purchase for it to be replaced.

If the fault develops after 28 days and within 12 months of original purchase, you should contact the Helpline number quoting Model number and Serial number on the product, or write to Morphy Richards at the address shown.

You may be asked to return a copy of proof of purchase.

Subject to the exclusions set out below (see Exclusions), the faulty appliance will then be repaired or replaced as appropriate and dispatched usually within 7 working days of receipt.

If, for any reason, this item is replaced or repaired during the 1 year guarantee period, the guarantee on the new item will be calculated from original purchase date. Therefore it is vital to retain your original till receipt or invoice to indicate the date of initial purchase.

To qualify for the 1 year guarantee, the appliance must have been used according to the instructions supplied. For example, crumb trays should have been emptied regularly.

Exclusions

Morphy Richards shall not be liable to replace or repair the goods under the terms of the guarantee where:

- 1 The fault has been caused or is attributable to accidental use, misuse, negligent use or used contrary to the manufacturer's recommendations or where the fault has been caused by power surges or damage caused in transit.
 - 2 The appliance has been used on a voltage supply other than that marked on the products.
 - 3 Repairs have been attempted by persons other than our service staff (or authorised dealer).
 - 4 The appliance has been used for hire purposes or non domestic use.
 - 5 The appliance is second hand.
 - 6 Morphy Richards reserves the right not to carry out any type of servicing under the guarantee at its discretion
 - 7 Batteries and damage from leakage are not covered by the guarantee.
- This guarantee does not confer any rights other than those expressly set out above and does not cover any claims for consequential loss or damage. This guarantee is offered as an additional benefit and does not affect your statutory rights as a consumer. Morphy Richards products are intended for household use only. See usage limitations within the location safety instructions.

Disclaimer

Morphy Richards has a policy of continuous improvement in product quality and design. The company, therefore reserves the right to change the specification of it's models at any time.



For electrical products sold within the European Community. At the end of the electrical products useful life, it should not be disposed of with household waste.

Please recycle where facilities exist. Check with your Local Authority or retailer for recycling advice in your country

**IF YOU ARE HAVING A PROBLEM
WITH ONE OF OUR PRODUCTS, CALL
OUR HELPLINE:**

**UK: 0344 871 0944
EIRE: 1800 409 119
SPARES: 0344 873 0710**

morphyrichards

The After Sales Division
Morphy Richards Ltd
Mexborough, South Yorkshire,
England, S64 8AJ

Helplines (office hours)
UK 0344 871 0944
Spare Parts 0344 873 0710
Republic of Ireland 1800 409 119
www.morphyrichards.com

