

SC460020 MUK Rev 1

**morphyrichards®**  
smart ideas for your home



## Sear and Stew Hinged Lid Slow Cooker

 Please read and keep these instructions for future use

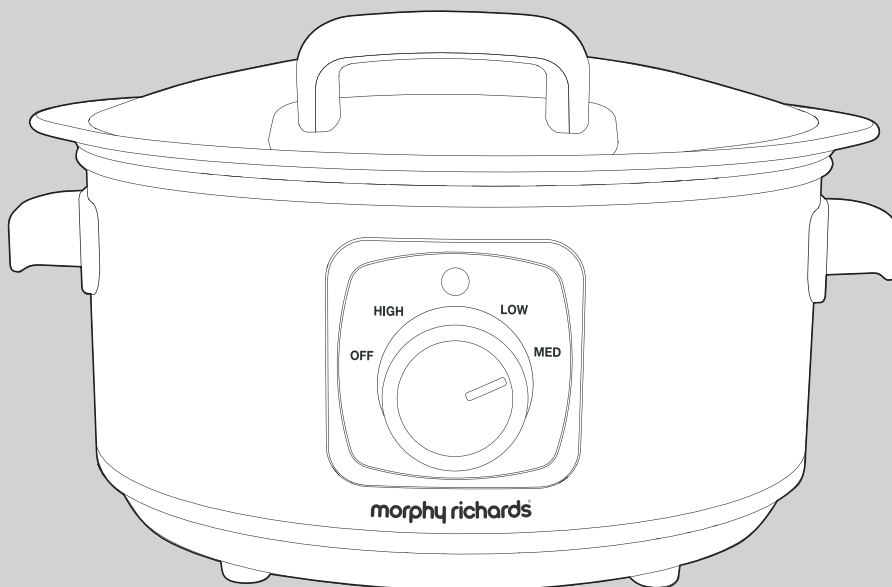

For competitions, product hints and tips  
and more join us at



[www.morphyrichards.co.uk/blog](http://www.morphyrichards.co.uk/blog)



[www.facebook.com/morphyrichardsuk](https://www.facebook.com/morphyrichardsuk)



[@loveyourmorphy](https://twitter.com/loveyourmorphy)

[www.morphyrichards.com](http://www.morphyrichards.com)

\* Register online for your 2 year guarantee. See the back of this instruction book for details (UK and Ireland customers only).

## Health And Safety

The use of any electrical appliance requires the following common sense safety rules.  
**Please read these instructions carefully before using the product.**

- This appliance can be used by children aged from 8 years and above if they have been given supervision or instruction concerning use of the appliance in a safe way and if they understand the hazards involved. Cleaning and user maintenance shall not be made by children unless they are older than 8 and supervised. Keep the appliance and its cord out of the reach of children aged less than 8 years. Children shall not play with the appliance.
- **WARNING:** This appliance contains an element which is subject to residual heat after use.
- Appliances can be used by persons with reduced physical, sensory or mental capabilities or lack of experience and knowledge if they have been given supervision or instruction concerning use of the appliance in a safe way and understand the hazards involved.
- **WARNING:** Misuse of appliance could cause potential injury.
- Do not immerse Base Unit in water.
- This appliance is intended to be used in household and similar applications such as: farm houses, by clients in hotels, motels and other residential type environments, and bed and breakfast type environments. It is not suitable for use in staff kitchen areas in shops, offices and other working environments.
- If the supply cable is damaged, it must be replaced by the manufacturer, its service agent or similarly qualified persons in order to avoid a hazard.

### Location

- Always locate your appliance away from the edge of the worktop.
- Ensure that the appliance is used on a firm, flat, heat resistant surface.
- Do not use the appliance outdoors or near water.

### Mains cable

- The mains cable should reach from the socket to the appliance without straining the connections.
- Do not let the mains cable hang over the edge of the worktop or open space where a child could reach it.
- Do not let the cable run across a cooker or hot area which might damage the cable.

### Other safety considerations

- Do not switch on the Slow Cooker if the Cooking Pot is empty.
- Allow the Glass Lid and Cooking Pot to cool before immersing in water.
- Never cook directly on the Base Unit. Use the Cooking Pot.
- Do not switch on the Base Unit without the Cooking Pot in place.
- Switch off the Base Unit before removing the Cooking Pot.
- Do not use the Cooking Pot or Glass Lid if cracked or chipped.
- Do not switch on the appliance when it is upside down or laid on its side.

- The Glass Lid and Cooking Pot are fragile. Handle them with care.
- The use of attachments or tools not recommended by Morphy Richards may cause fire, electric shock or injury.
- Do not place on or near a hot gas or electric burner or in a heated oven.
- Unplug from the socket when not in use, before putting on or taking off attachments, and before cleaning.

### Personal safety

- **WARNING: Do not touch the top of the appliance or other hot parts during or after use, use handles or knobs. Misuse of this appliance could cause potential injury.**
- To protect against the risk of electrical shock do not put base in water or in any other liquid.
- Do not touch hot surfaces. Use oven gloves or a cloth when removing lid or handling hot containers.
- Extreme caution must be used when moving an appliance containing hot food, water, or other hot liquids.

### Electrical requirements

Check that the voltage on the rating plate of your appliance corresponds with your house electricity supply which must be A.C. (Alternating Current).

Should the fuse in the mains plug require changing, a 3 amp BS1362 fuse must be fitted.

**WARNING: This appliance must be earthed.**

## Introduction

Thank you for purchasing your new Morphy Richards Slow Cooker.

Your Sear and Stew Slow Cooker will allow you to create an extensive selection of meals with the added benefit of being able to sear the meat in the same pan. Searing meat in the Cooking Pot means that the juices from the meat combine with the rest of the ingredients creating richer fuller flavours in your dishes.

## Contents

<b>Health And safety</b> .....	<b>2</b>
<b>Before First Use</b> .....	<b>3</b>
<b>Features</b> .....	<b>4</b>
<b>Using Your Slow Cooker</b> .....	<b>5</b>
<b>Handling The Cooking Pot</b> .....	<b>6</b>
<b>Handling The Hinged Glass Lid</b> .....	<b>6</b>
<b>Foods For Slow Cooking</b> .....	<b>7</b>
<b>Slow Cooking Tips</b> .....	<b>7</b>
<b>Care And Cleaning</b> .....	<b>8</b>
<b>Caring For The Lid And Cooking Pot</b> .....	<b>8</b>
<b>Troubleshooting</b> .....	<b>8</b>
<b>Recipes / Cooking Guide</b> .....	<b>9</b>
<b>Recipes - Soup</b> .....	<b>10</b>
<b>Recipes - Poultry</b> .....	<b>10</b>
<b>Recipes - Meat</b> .....	<b>11</b>
<b>Recipes - Dessert</b> .....	<b>15</b>
<b>Trouble Shooting</b> .....	<b>16</b>
<b>Contact Us</b> .....	<b>16</b>
<b>Notes</b> .....	<b>17</b>
<b>Guarantee</b> .....	<b>20</b>

## Before First Use

Wash the Hinged Glass Lid (2) and Cooking Pot (3) in hot, soapy water. Rinse and dry.

## Note

The Cooking Pot is not suitable for use on an induction hob.

## Product Overview

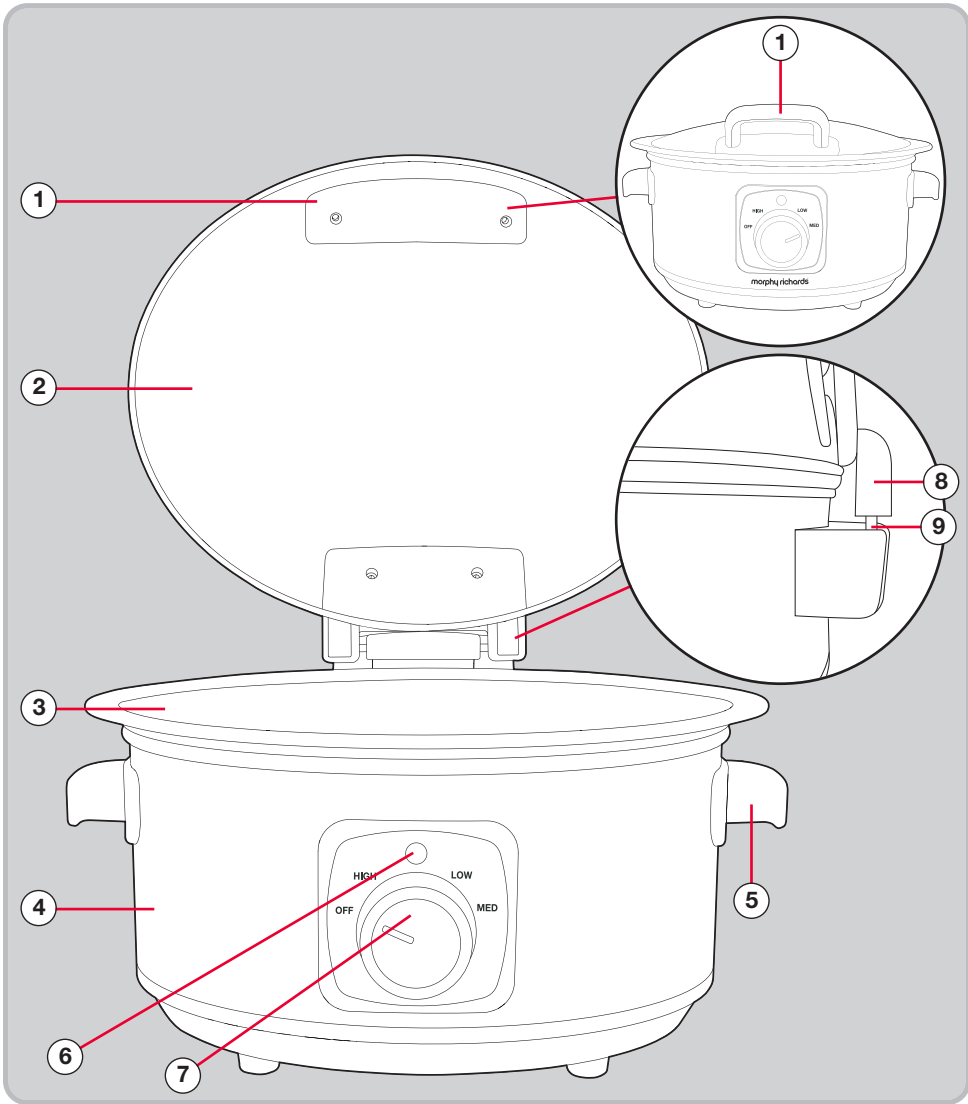

## Features

- |                      |                         |
|----------------------|-------------------------|
| (1) Lid Handle       | (6) Indicator Light     |
| (2) Hinged Glass Lid | (7) Control Knob        |
| (3) Cooking Pot      | (8) Hinged Lid Mount    |
| (4) Base Unit        | (9) Lid Mounting Spigot |
| (5) Base Handles     |                         |

## Using Your Slow Cooker

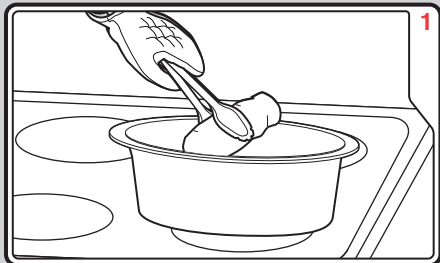

1

Add oil to Cooking Pot (3). Refer to the recipe for the correct amount of oil to use.

Preheat the oil in the Cooking Pot on the hob over a medium-high heat. The Cooking Pot is compatible with most hobs, except induction.

When the oil is hot, add the meat in to the Cooking Pot. **WARNING: The Cooking Pot will be hot. Handle with oven gloves.**

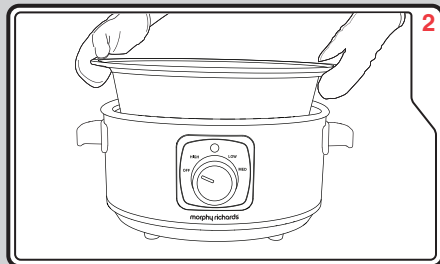

2

When the meat has seared, place the Cooking Pot into the Base Unit (4). **WARNING: The Cooking Pot will be hot. Handle with oven gloves.**

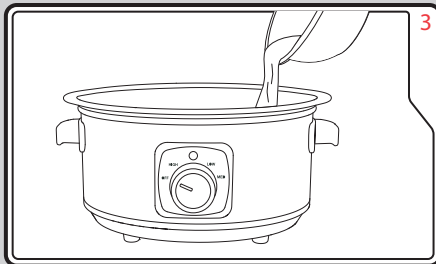

3

Add the rest of the ingredients to the Cooking Pot. Stir with a wooden spoon.

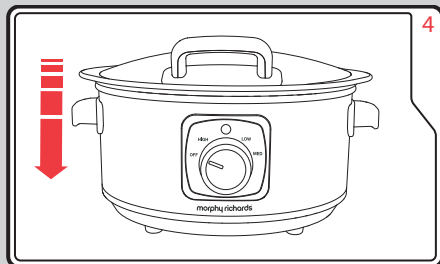

4

Fit the Hinged Glass Lid (2) on the Cooking Pot.

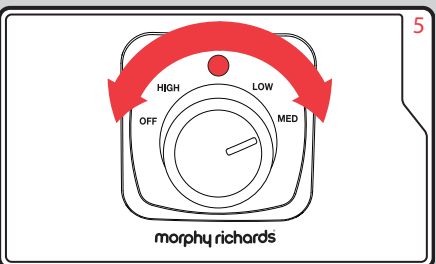

5

Select Low, Medium or High cooking setting on the Control Knob (7) to start slow cooking. The Indicator Light (6) will illuminate.

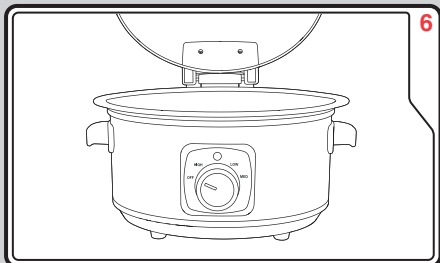

6

When cooking has finished (refer to the Cooking Guide on page 9), turn the Control Knob (7) to Off. The Indicator Light (6) will switch off.

Lift the Hinged Glass Lid (2) and serve.

Note: The Lid (2) must be removed before the Cooking Pot (3) can be removed from the Base Unit (4).

## Handling The Cooking Pot

- **WARNING: The Cooking Pot (3) will become very hot when in use.**
- To prevent the Cooking Pot (3) from slipping when using to sear, sauté or fry the ingredients on your hob, use an oven glove to support the Cooking Pot (3) when stirring the food.
- Be careful when using the Cooking Pot (3) on a gas hob, select the correct size gas burner to fit the base area of the Cooking Pot (3). **DO NOT use on a wok burner or oversized gas hob.**
- **Do not use metal utensils to stir food in the Cooking Pot (3) as this will scratch and remove the non stick coating. Use either wood or silicone plastic utensils.**
- **WARNING: The Lid Handle (1), the Base Unit (4) and the Cooking Pot (3), as well as the outside of the Base Unit, all become hot during cooking. Always use oven gloves when handling ANY part of the Slow Cooker during cooking.**

## Handling the Hinged Glass Lid

- **WARNING: Be aware that the contents of the Cooking Pot (3) will be hot and a burst of steam may be emitted when opening the Hinged Glass Lid (2).**
- It is not usually necessary to open the Lid (2) during cooking, however towards the end of cooking, gravy or sauce may need thickening or dumplings may be added.
- To open the Lid (2), hold the Lid Handle (1) and raise so that it sits fully upright on its hinge at the back of the slow cooker, add the cornflour paste or other ingredients according to the recipe, stir well and then lower the Lid (2) carefully using its handle until cooking is complete.
- **Do not drop the Glass Lid from its raised position onto the Cooking Pot (3) as this may cause damage.**

## Fitting the Hinged Glass Lid

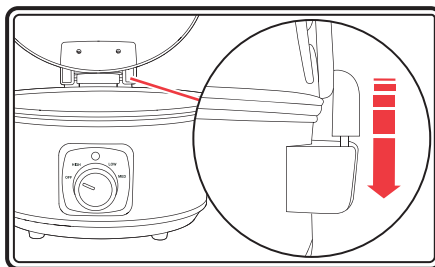

Holding the Hinged Glass Lid (2) by its handle, place the Hinged Lid Mount (8) onto the Lid Mounting Spigot (9).

To remove the Hinged Glass Lid (2) for cleaning, with the Lid (2) in the upright position, hold the Lid Handle (1) and simply lift the Lid off the Mounting Spigot (9).

Note: the Hinged Glass Lid (2) must be removed before the Cooking Pot (3) can be removed from the Base Unit (4).

## Foods For Slow Cooking

- Most foods are suited to slow cooking methods, however there are a few guidelines that need to be followed.
- Ensure all frozen ingredients are thoroughly defrosted prior to cooking.
- Cut root vegetables into small, even pieces, as they take longer to cook than meat. They can be gently sauteed for 2-3 minutes before slow cooking. Ensure that root vegetables are always placed at the bottom of the Cooking Pot (3) and all ingredients are immersed in the cooking liquid.
- Trim all excess fat from meat before cooking, as the slow cooking method does not allow fat to evaporate.
- If adapting an existing recipe from conventional cooking, you may need to reduce the amount of liquid used. Liquid will not evaporate from your Slow Cooker to the same extent as conventional cooking.
- Never leave uncooked food at room temperature in your Slow Cooker.
- Uncooked kidney beans must be soaked overnight and boiled for at least 10 minutes to remove toxins before use in a Slow Cooker.
- Insert a meat thermometer into joints of ham or whole chicken to ensure they are cooked to the desired temperature.
- **Do not use your Slow Cooker to reheat food.**

## Slow Cooking Tips

- The Slow Cooker must be at least half full for best results.
- Slow cooking retains moisture. If you wish to reduce liquid, remove the Lid after cooking and turn the control to High. Reduce the moisture by simmering for 30 to 45 minutes.
- If cooking soups, leave 5 cm gap from the rim of the Cooking Pot (3) and the food surface to allow for simmering.
- Removing the Hinged Glass Lid (2) will allow heat to escape, reducing the efficiency of your Slow Cooker and increasing the cooking time. If you remove the Lid to stir or add ingredients, you will need to allow 10-15 minutes extra cooking time for each time you remove it.
- Many things can affect how quickly a recipe will cook, including water and fat content, initial temperature of the food and the size of the food. Check food is properly cooked before serving.

- Many recipes will take several hours to cook. If you don't have time to prepare food in the morning, prepare it the night before, storing the food in a covered container in the fridge. Transfer the food to the Cooking Pot and add boiling liquid/stock. In most of the recipes in this book, the meat ingredients are browned first to improve their appearance and flavour.
- If you are short on preparation time and would prefer to skip the searing stage, simply add your meat and other ingredients into your Slow Cooker and cover with boiling liquid/stock. You will need to increase the recipe cooking time as follows: High setting +1 hour, Medium setting +1-2 hours, Low Setting +2-3 hours.
- Most meat and vegetable recipes require 8-10 hours on Low, 6-8 hours on Medium and 4-6 hours on High. Cook chicken dishes for the minimum time for the setting.
- Some ingredients are not suitable for slow cooking. Pasta, seafood, milk and cream should be added towards the end of the cooking time.
- Pieces of food cut into small pieces will cook quicker. A degree of 'trial and error' will be required to fully optimise the potential of your Slow Cooker.
- All food should be covered with a liquid, gravy or sauce. In a separate pan or jug, prepare your liquid, gravy or sauce and completely cover the food in the Cooking Pot (3).
- When cooking joints of meat, ham, poultry etc, the size and shape of the joint is important. Try to keep the joint in the lower 2/3 of the pot. If necessary, cut into two pieces. Joint weight should be kept within the maximum limit of 1kg for 3.5L Slow Cooker and 2kg for 6.5L Slow Cooker.
- For ham and brisket fill with hot water to just cover the joint. For beef, pork or poultry cover to 1/3 depth.

## Care And Cleaning

- Turn off and unplug your Slow Cooker from the mains. Allow to cool completely before cleaning.
- Do not use metal utensils or abrasive cleaners when cleaning.
- Remove the Hinged Glass Lid (2) and Cooking Pot (3) and wash in hot soapy water, rinse, allow to drain and dry.
- Wipe the sides of the Base Unit (4) with a damp cloth.
- The Hinged Glass Lid (2) and Cooking Pot (3) only are dishwasher safe.
- When using a dishwasher to clean the Hinged Glass Lid (2) and Cooking Pot (3), place on the top shelf on a short/cool wash. Allow the Lid to drain after washing.

### DO NOT IMMERSE THE BASE UNIT IN WATER

## Caring For The Hinged Glass Lid And Cooking Pot

- Please handle the Hinged Glass Lid (2) and Cooking Pot (3) carefully to ensure long life.

- Avoid sudden, extreme temperature changes to the Hinged Glass Lid (2). For example, do not place the hot Lid into cold water or onto a wet surface.
- Avoid hitting the Hinged Glass Lid (2) against any hard surfaces and do not allow the Lid to fall from its raised position. Lower it carefully onto the Cooking Pot (3).
- Do not use the Hinged Glass Lid (2) if chipped, cracked or severely scratched.
- Do not use abrasive cleansers or metal scouring pads.
- Never heat the Cooking Pot (3) when empty. When searing or browning add the meat as soon as the oil is hot.
- Never place the Hinged Glass Lid (2) or Cooking Pot (3) under a grill, in the oven, in a microwave or toaster oven.
- Never place the Hinged Glass Lid (2) directly on a burner or hob.
- Do not use metal utensils when searing or to stir food in the Cooking Pot (3) as this will scratch and remove the non stick coating. Use either wooden or silicone plastic utensils.

## Troubleshooting

Problem	Reason	Solution
<ul style="list-style-type: none"> <li>• Food is undercooked.</li> </ul>	<ul style="list-style-type: none"> <li>• Loss of power</li> <li>• Food cooked on wrong setting for cooking time</li> <li>• Glass Lid not placed correctly on the Cooking Pot</li> </ul>	<ul style="list-style-type: none"> <li>• Test the mains outlet with a lamp known to be working.</li> <li>• Check the Control Knob position and the recipe details.</li> <li>• Check the Glass Lid is correctly placed and nothing is obstructing it.</li> </ul>
<ul style="list-style-type: none"> <li>• Food is overcooked.</li> </ul>	<ul style="list-style-type: none"> <li>• Cooking Pot was under half full</li> <li>• Food cooked too long</li> <li>• Cooking Pot placed in Base Unit while still very hot.</li> </ul>	<ul style="list-style-type: none"> <li>• Your Slow Cooker has been designed to thoroughly cook food in a filled Cooking Pot. If the Cooking Pot is only half-filled, check to see if the food is cooked 1 to 2 hours earlier than recipe time.</li> <li>• Check the Control Knob position and the recipe details.</li> <li>• Cooking time may be shortened. Check food is cooked 30 minutes to 1 hour earlier than the stated recipe time.</li> </ul>



## Recipes



We have developed 12 recipes for you to use in the Sear and Stew Slow Cooker. From soup for starters, curries for mains and sponge pudding for dessert, there are choices for all tastes.

Please be aware that for these recipes there are two ingredient lists for different Slow Cooker capacities. Please ensure you refer to the correct recipe for your Slow Cooker model.

The cooking times given in the following recipes are a guide. Should you want to increase or decrease the cooking time, please refer to the Cooking Guide below. Please note that these cooking times are for guidance only and may vary depending on food type and personal taste.

The 6.5L Slow Cooker has a maximum working capacity of 5 litres (10½ pints). The 3.5L Slow Cooker has a maximum working capacity of 2.5 litres (4½ pints). The capacity may be found on the rating plate underneath the Base Unit. This allows a 2cm space between the top of the Cooking Pot and the food.

## Cooking Guide

### Cook on High

- 4-6 hours

### Cook on Medium

- 6-8 hours

### Cook on Low

- 8-10 hours

See individual recipes for guidance for best cooking settings.

## Recipes - Soup

### Vegetable Soup

#### Ingredients:

- |   | 3.5L                 | 6.5L  |   |
|---|----------------------|-------|---|
| • | 30g                  | 60g   | Butter  |
| • | 1.25kg               | 1.8kg | Mixed vegetables, e.g. potatoes, onions, carrots, parsnips, celery, leeks, tomatoes |
| • | 1.1L                 | 2L    | Vegetable stock   |
| • | Mixed herbs to taste |       |   |
| • | Salt and pepper      |       |   |
| • | 30g                  | 60g   | Plain flour   |

#### Method:

- 1 Peel, wash and cube or slice all the vegetables.
- 2 Melt butter in the Cooking Pot and gently fry the vegetables on the hob for 2-3 minutes.
- 3 Add the hot stock. Stir well and bring to the boil. Season to taste and add mixed herbs.
- 4 Transfer the Cooking Pot into the Base Unit.
- 5 Cover with the Hinged Glass Lid and cook for 8-10 hours on the Low setting, 6-8 hours on Medium setting or 4-6 hours on the High setting.
- 6 Cool and liquidise the soup.
- 7 Reheat on the hob, thickening the soup with the flour if necessary.

## Recipes - Poultry

### Chicken in White Wine Sauce

#### Ingredients:

- |   | 3.5L            | 6.5L   |                              |
|---|-----------------|--------|------------------------------|
| • | 4               | 10     | Chicken breasts              |
| • | 20g             | 40g    | Butter                       |
| • | 1               | 2      | Large onions, finely chopped |
| • | 125g            | 400g   | Mushrooms, sliced            |
| • | 3 tbsp          | 5 tbsp | Dry white wine               |
| • | 400ml           | 750ml  | Chicken stock                |
| • | 1 tsp           | 2 tsp  | Mixed herbs                  |
| • | 2 tbsp          | 3 tbsp | Cornflour                    |
| • | 2               | 3      | Egg yolks                    |
| • | 75ml            | 150ml  | Double cream                 |
| • | Salt and pepper |        |                              |

#### Method:

- 1 Place the chicken breasts and butter in the Cooking Pot and gently fry on the hob until sealed on all sides. Remove and set aside.
- 2 Add the onion and fry until softened but not browned. Add the mushrooms and cook for a minute on a low heat. Replace the chicken into the Pot.
- 3 Blend the cornflour with a splash of wine. Pour the remaining wine into the Cooking Pot with the blended cornflour, mixed herbs and seasoning. Bring to the boil, stirring continuously until thickened.
- 4 Transfer the Cooking Pot into the Base Unit, cover with the Hinged Glass Lid.
- 5 Cook for 8 hours on the Low setting, 6 hours on Medium setting or 4 hours on the High setting.
- 6 Just before serving, beat together the egg yolks and cream. Beat in a few tablespoons of the cooking liquid, mix well together. Pour this mixture into the Cooking Pot and stir until the sauce thickens.

## Recipes - Meat

### Beef Stew

#### Ingredients:

- | 3.5L              | 6.5L   |                            |
|-------------------|--------|----------------------------|
| • 1 tbsp          | 2 tbsp | Cooking oil                |
| • 500g            | 1kg    | Stewing beef, cubed        |
| • 1               | 2      | Large onion(s), chopped    |
| • 1               | 2      | Garlic clove(s), crushed   |
| • 400g            | 700g   | Potatoes, peeled and cubed |
| • 400g            | 700g   | Carrots, peeled and sliced |
| • 2               | 3      | Large leeks, sliced        |
| • 750ml           | 1.5L   | Beef stock                 |
| • 1 tbsp          | 3 tbsp | Cornflour                  |
| • 2 tsp           | 3 tsp  | Mixed herbs                |
| • Salt and pepper |        |                            |

#### Method:

- 1 Heat the cooking oil in the Cooking Pot on the hob and fry the meat in batches. Remove and set aside. Add the onions and garlic and fry until softened.
- 2 Add the potatoes, carrots and leeks and replace the meat into the Cooking Pot.
- 3 Add the stock and the mixed herbs. Add to the Cooking Pot and season to taste.
- 4 Transfer the Cooking Pot into the Base Unit.
- 5 Cover with the Hinged Glass Lid and cook for 8-10 hours on the Low setting, 6-8 hours on the Medium setting or 4-6 hours on the High setting.
- 6 Before serving, thicken the sauce with the cornflour. Mix the cornflour with a little cold water until a smooth paste is achieved. Mix this into a cup of the hot liquid taken from the Cooking Pot, when fully mixed into the liquid add this back into the rest of the ingredients and stir well until the cornflour is evenly distributed. This can be done 30 minutes from the end of the cooking time.

### New England Beef

#### Ingredients:

- | 3.5L                                     | 6.5L   |                   |
|--|--------|-------------------|
| • 1 tbsp                                 | 2 tbsp | Cooking oil       |
| • 750g                                   | 1.5kg  | Brisket of beef   |
| • 1                                      | 1      | Bouquet garni     |
| • 1 tsp                                  | 2 tsp  | Thyme             |
| • 1 tsp                                  | 2 tsp  | Black peppercorns |
| • 6                                      | 10     | Shallots          |
| • 330g                                   | 550g   | Carrots, sliced   |
| • 150g                                   | 300g   | Swede, diced      |
| • Beef Stock (enough to cover the joint) |        |                   |

#### Method:

- 1 Put the oil into the Cooking Pot on the hob, heat gently. Add the beef and sear on all sides.
- 2 Add all the remaining ingredients. Cover the beef with stock to submerge the joint.
- 3 Season well and then transfer the Cooking Pot into the Base Unit, cover with the Hinged Glass Lid.
- 4 Cook for 8-10 hours on the Low setting, 6-8 hours on the Medium setting or 4-6 hours on the High setting.
- 5 Take the beef out of the Cooking Pot with a slotted spoon and allow to cool for 10 minutes. The cooking liquid can be used as a base to make gravy.
- 6 Cut the beef into slices and spoon a little of the cooking liquid over. Serve with vegetables and garnish with fresh parsley.

**IMPORTANT:** When buying a joint of meat, ensure it will fit into the Cooking Pot, so when it is covered with liquid it will be 2.5cm below the rim. The joint must not stick out above the rim and there should be enough room to cover the meat with water. The shape of the meat is just as important as the weight.

## Recipes - Meat

### Thai Beef Curry

#### Ingredients:

	3.5L	6.5L	
•	30g	60g	Butter
•	500g	1kg	Stewing beef, cubed
•	1	2	Onion(s), chopped
•	2	4	Garlic cloves, crushed
•	3 tbsp	6 tbsp	Peanut butter
•	400g	800g	Coconut milk
•	400g	700g	Potatoes, quartered
•	2 tbsp	4 tbsp	Curry powder
•	2 tbsp	4 tbsp	Thai fish sauce
•	2 tbsp	4 tbsp	Soft brown sugar
•	500ml	1L	Beef stock

#### Method:

- 1 Melt the butter in the Cooking Pot on the hob and gently brown the beef in batches.
- 2 Add the onions and garlic and fry until soft.
- 3 Add the remaining ingredients and mix well.
- 4 Transfer the Cooking Pot into the Base Unit, cover with the Hinged Glass Lid.
- 5 Cook for 8-10 hours on the Low setting, 6-8 hours on Medium setting or 4-6 hours on the High setting.

Note: a slight 'crust' of brown meat may appear on the top. It soon disappears if stirred into the sauce.

### Beef Curry

#### Ingredients:

	3.5L	6.5L	
•	5 tbsp	5 tbsp	Vegetable oil
•	2	3	Medium cooking apples, peeled, cored and sliced
•	2	3	Large onions, chopped
•	750g	1.5kg	Stewing steak, cubed
•	3 tsp	5 tsp	Curry powder
•	500ml	1L	Beef stock
•	3 tbsp	5 tbsp	Mango chutney
•	75g	150g	Sultanas
•	300g	600g	Tinned tomatoes, chopped
•	2 tbsp	3 tbsp	Lemon juice
•	2 tbsp	5 tbsp	Cornflour
•			Salt and pepper

#### Method:

- 1 Add 2 tbsp of the oil, the apple and onion to the Cooking Pot and fry on the hob until soft. Remove and set aside.
- 2 Sear the steak in batches in the Cooking Pot and fry in the remaining oil, as required.
- 3 Add the remaining ingredients with the exception of the cornflour and stir well.
- 4 Transfer the Cooking Pot into the Base Unit, cover with the Hinged Glass Lid.
- 5 Cook for 8-10 hours on the Low setting, 6-8 hours on Medium setting or 4-6 hours on the High setting.
- 6 At the end of the cooking time, thicken with the cornflour. Mix the cornflour with a little cold water until a smooth paste is achieved. Mix this into a cup of the hot liquid taken from the Cooking Pot, when fully mixed into the liquid add this back into the rest of the ingredients and stir well until the cornflour is evenly distributed. This can be done 30 minutes from the end of the cooking time.

## Bolognese

### Ingredients:

3.5L 6.5L

- 800g 1.5kg Minced beef
- 2 3 Onions, chopped
- 3 6 Celery sticks, thinly sliced
- 2 3 Garlic cloves, crushed
- 4 tbsp 7 tbsp Tomato puree
- 2 tbsp 3 tbsp Plain flour
- 2x400g 3x400g Cans chopped tomatoes
- 300ml 600ml Beef stock
- 150g 300g Mushrooms, sliced
- 1 tsp 2 tsp Mixed herbs
- Salt and pepper

### Method:

- 1 In the Cooking Pot, gently brown the mince on the hob without adding any fat or oil.
- 2 When the fat has started to run from the meat, add the onion, celery and garlic.
- 3 Fry for a couple of minutes and then add the remaining ingredients and stir well.
- 4 Transfer the Cooking Pot into the Base Unit, cover with the Hinged Glass Lid.
- 5 Cook for 8-10 hours on the Low setting, 6-8 hours on Medium setting or 4-6 hours on the High setting.

Note: a slight 'crust' of brown meat may appear on the top. It soon disappears if stirred into the sauce.

## BBQ Spare Ribs

### Ingredients:

3.5L 6.5L

- 1.5kg 3kg Pork spare ribs
- 300ml 600ml BBQ sauce

### Method:

- 1 Marinade the ribs in the sauce for a few hours, preferably overnight.
- 2 Place in the Cooking Pot and cover with the Hinged Glass Lid.
- 3 Cook for 8-10 hours on the Low setting, 6-8 hours on Medium setting or 4-6 hours on the High setting.

## Recipes - Meat

### Boiled Ham

#### Ingredients:

3.5L 6.5L

- 1kg 1.8kg (max) Gammon joint

#### Method:

- 1 Remove the packaging from the joint but leave any collar in place. Rinse under cold running water.
- 2 Place the gammon joint into the Cooking Pot with sufficient boiling water to roughly cover the joint.
- 3 Transfer the Cooking Pot to the Base Unit, cover with the Hinged Glass Lid.
- 4 Cook for 8-10 hours on the Low setting, 6-8 hours on Medium setting or 4-6 hours on the High setting.

**IMPORTANT:** When buying a joint of meat, ensure it will fit into the Cooking Pot. The joint must not protrude above the rim. The shape of the meat is just as important as the weight.

### Sausage Pot

#### Ingredients:

3.5L 6.5L

- 1 tbsp 1tbsp Oil
- 750g 1.5kg Good quality sausages
- 1 3 Large onion(s), finely chopped
- 2 5 Carrots, thinly sliced
- 2 3 Leeks, sliced
- 3 tbsp 5 tbsp Plain flour
- 750ml 1.5L Beef stock
- 3 tbsp 6 tbsp Chutney
- 3 tbsp 5 tbsp Worcestershire sauce
- Salt and pepper

#### Method:

- 1 In the Cooking Pot, sear the sausages in batches on the hob on all sides in the oil. Remove from the Cooking Pot and set aside.
- 2 Add the onions, carrots and leeks and gently saute until softened, but not browned.
- 3 Stir in the flour and cook on a low heat until the oil is absorbed.
- 4 Slowly add the stock and stir well.
- 5 Stir in the chutney, Worcestershire sauce and seasoning.
- 6 Place the sausages back into the Cooking Pot.
- 7 Transfer the Cooking Pot into the Base Unit, cover with the Hinged Glass Lid.
- 8 Cook for 8-10 hours on the Low setting, 6-8 hours on Medium setting or 4-6 hours on the High setting.

If the sausages contain a lot of fat, any excess can be removed from the surface of the finished dish with kitchen paper.

## Recipes - Dessert

### Rice Pudding

#### Ingredients:

- |   | 3.5L  | 6.5L |              |
|---|-------|------|--------------|
| • | 30g   | 60g  | Butter       |
| • | 130g  | 250g | Pudding rice |
| • | 130g  | 250g | Sugar        |
| • | 1.2L  | 2L   | Milk         |
| • | pinch | 1tsp | Nutmeg       |

#### Method:

- 1 Butter the sides of the Cooking Pot.
- 2 Add all the ingredients and stir well.
- 3 Transfer the Cooking Pot into the Base Unit, cover with the Hinged Glass Lid.
- 4 Cook for 8-10 hours on the Low setting, 6-8 hours on Medium setting or 4-6 hours on the High setting.

### Sponge Pudding

#### Ingredients:

- |   |        |                    |
|---|--------|--------------------|
| • | 125g   | Butter             |
| • | 4 tbsp | Golden syrup       |
| • | 100g   | Caster sugar       |
| • | 2      | Eggs, beaten       |
| • | 200g   | Self raising flour |
| • | 2 tbsp | Milk               |
| • | 2 tbsp | Lemon juice        |

#### Method:

- 1 Lightly grease the inside of a 1.25L pudding basin and line the bottom with greaseproof paper.
- 2 Pour the syrup into the bottom of the basin.
- 3 In a mixing bowl, cream the butter and sugar until smooth and creamy.
- 4 Gradually mix in the eggs and flour and stir in the milk and lemon juice.
- 5 Spoon the mixture on top of the syrup and cover with pleated baking paper. Tie with string to secure and make a handle.
- 6 Place into the Cooking Pot and fill with boiling water halfway up the sides of the basin.
- 7 Cover with the Hinged Glass Lid and cook for 8-10 hours on the Low setting, 6-8 hours on Medium setting or 4-6 hours on the High setting.

## Troubleshooting

### Problem

- Food is undercooked.

### Reason

- Loss of power
- Food cooked on wrong setting for cooking time
- Hinged Glass Lid not placed correctly on the Cooking Pot

### Solution

- Test the mains outlet with a lamp known to be working.
- Check the Control Knob position and the recipe details.
- Check the Hinged Glass Lid is correctly placed and nothing is obstructing it.

- Food is overcooked.

- Cooking Pot was under half full
- Food cooked too long
- Cooking Pot placed in Base Unit while still very hot.

- The Slow Cooker has been designed to thoroughly cook food in a filled Cooking Pot. If the Cooking Pot is only half-filled, check to see if the food is cooked 1 to 2 hours earlier than recipe time.
- Check the Control Knob position and the recipe details.
- Cooking time may be shortened. Check food is cooked 30 minutes to 1 hour earlier than the stated recipe time.

## Contact us

### Helpline

If you are having a problem with your appliance, please call our Helpline, as we are more likely to be able to help than the store you purchased the item from.

Please have the product name, model number and serial number to hand when you call to help us deal with your enquiry quicker.

UK Helpline: **0344 871 0944**

IRE Helpline: **1800 409 119**

Spares: **0344 873 0710**

### Talk To Us

If you have any questions, comments, want some great tips or recipe ideas to help you get the most out of your products, join us online:

Blog: **[www.morphyrichards.co.uk/blog](http://www.morphyrichards.co.uk/blog)**

Facebook: **[www.facebook.com/morphyrichardsuk](https://www.facebook.com/morphyrichardsuk)**

Twitter: **[@loveyourmorphy](https://twitter.com/loveyourmorphy)**

Website: **[www.morphyrichards.com](http://www.morphyrichards.com)**









SC460020 MUK Rev 1 03/19

## Registering Your 2 Year Guarantee

Your standard one year guarantee is extended for an additional 12 months when you register the product within 28 days of purchase with Morphy Richards. If you do not register the product with Morphy Richards within 28 days, your product is guaranteed for 1 year. To validate your 2 year guarantee register with us online at [www.morphyrichards.co.uk](http://www.morphyrichards.co.uk)

Or call our customer registration line quoting model and serial number, these numbers can be found on the base of the product.

**UK 0344 871 0242**  
**IRE 1800 409 119**

N.B. Each qualifying product needs to be registered with Morphy Richards individually.

Please note that the 2 year guarantee is only available in the UK and Ireland. Please refer to the one year guarantee for more information.

## Your 1 Year Guarantee

It is important to retain the retailer's receipt as proof of purchase. Staple your receipt to this back cover for future reference.

Please quote the following information if the product develops a fault. These numbers can be found on the base of the product.

Model no.

Serial no.

All Morphy Richards products are individually tested before leaving the factory. In the unlikely event of any appliance proving to be faulty within 28 days of purchase, it should be returned to the place of purchase for it to be replaced.

If the fault develops after 28 days and within 12 months of original purchase, you should contact the Helpline number quoting Model number and Serial number on the product, or write to Morphy Richards at the address shown.

You may be asked to return a copy of proof of purchase.

Subject to the exclusions set out below (see Exclusions), the faulty appliance will then be repaired or replaced as appropriate and dispatched usually within 7 working days of receipt.

If, for any reason, this item is replaced or repaired during the 1 year guarantee period, the guarantee on the new item will be calculated from original purchase date. Therefore it is vital to retain your original till receipt or invoice to indicate the date of initial purchase.

To qualify for the 1 year guarantee, the appliance must have been used according to the instructions supplied. For example, crumb trays should have been emptied regularly.

## Exclusions

Morphy Richards shall not be liable to replace or repair the goods under the terms of the guarantee where:

- 1 The fault has been caused or is attributable to accidental use, misuse, negligent use or used contrary to the manufacturer's recommendations or where the fault has been caused by power surges or damage caused in transit.
  - 2 The appliance has been used on a voltage supply other than that stamped on the products.
  - 3 Repairs have been attempted by persons other than our service staff (or authorised dealer).
  - 4 The appliance has been used for hire purposes or non domestic use.
  - 5 The appliance is second hand.
  - 6 Morphy Richards reserves the right not to carry out any type of servicing under the guarantee at its discretion
  - 7 Plastic filters for all Morphy Richards kettles and coffee makers are not covered by the guarantee.
  - 8 Batteries and damage from leakage are not covered by the guarantee.
- This guarantee does not confer any rights other than those expressly set out above and does not cover any claims for consequential loss or damage. This guarantee is offered as an additional benefit and does not affect your statutory rights as a consumer. Morphy Richards products are intended for household use only. See usage limitations within the location safety instructions.

## Disclaimer

Morphy Richards has a policy of continuous improvement in product quality and design. The company, therefore reserves the right to change the specification of it's models at any time.



For electrical products sold within the European Community. At the end of the electrical products useful life, it should not be disposed of with household waste.

Please recycle where facilities exist. Check with your Local Authority or retailer for recycling advice in your country

**IF YOU ARE HAVING A PROBLEM  
WITH ONE OF OUR PRODUCTS,  
CALL OUR HELPLINE:**

**UK: 0344 871 0944**  
**EIRE: 1800 409 119**  
**SPARES: 0344 873 0710**

**morphyrichards**

The After Sales Division  
Morphy Richards Ltd  
Mexborough, South Yorkshire,  
England, S64 8AJ

Helplines (office hours)  
UK 0344 871 0944  
Spare Parts 0344 873 0710  
Republic of Ireland 1800 409 119  
[www.morphyrichards.com](http://www.morphyrichards.com)

